

Jackson, Mississippi Meeting Planner Guide

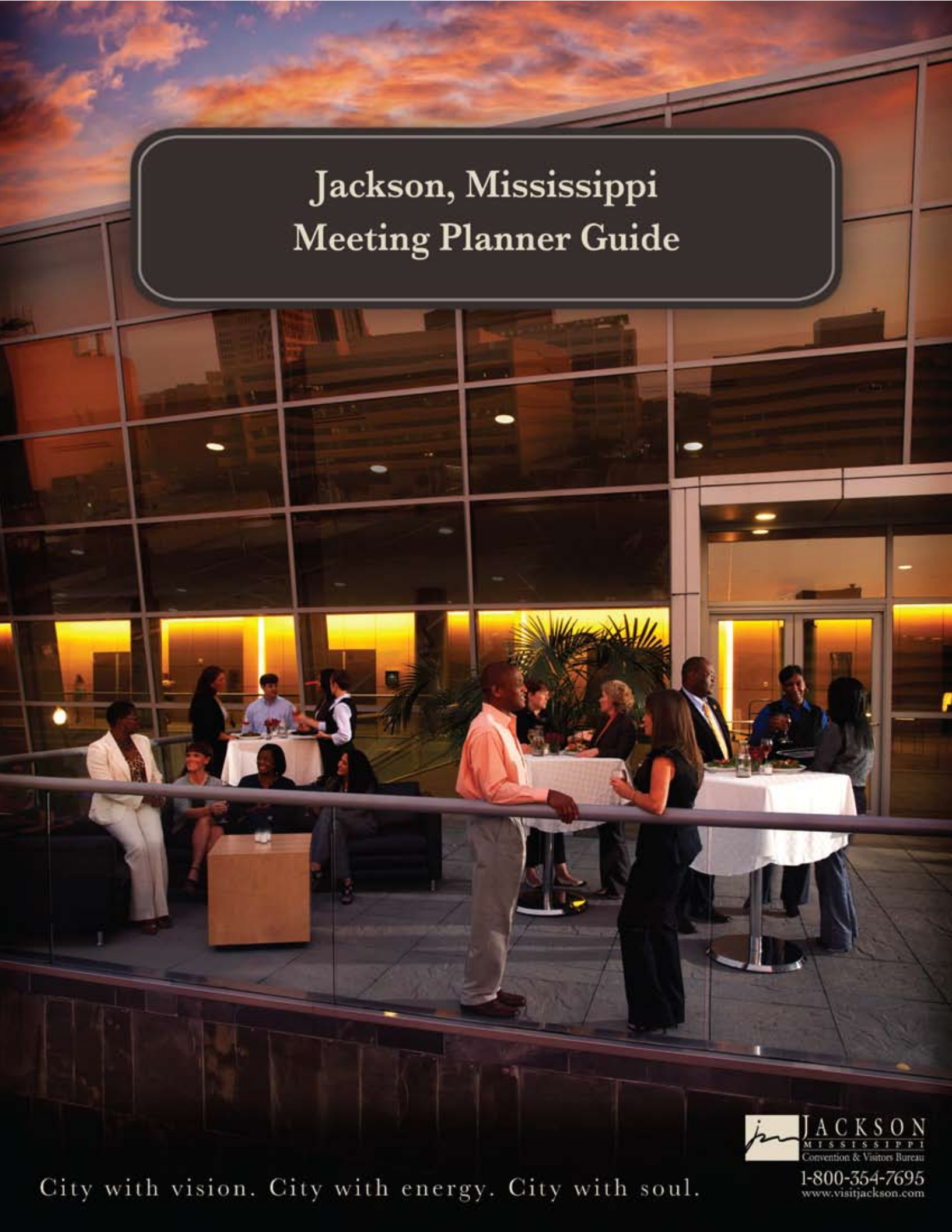

City with vision. City with energy. City with soul.

 **JACKSON**
MISSISSIPPI
Convention & Visitors Bureau
1-800-354-7695
www.visitjackson.com

*As the capital of Mississippi,
Jackson is a Southern city that will
show you a world of possibilities.
From unique, authentic festivals
to internationally renowned ballet.
Fascinating museums to smooth,
sassy blues. It's all here in a vibrant metropolis
of over half a million warm, friendly people.
Better still, Jackson offers more than
250 restaurants, nearly 5,000 hotel rooms,
and a charm that delights visitors again and again.
Of course, one visit is all it takes to discover why
Jackson is the city with soul.*

MEETING PLANNER CONTENTS



GENERAL FACTS	4
A BRIEF HISTORICAL SKETCH	5-6
TRANSPORTATION	7
MAPS	8-9
BUREAU SERVICES	10

MEETINGS IN JACKSON

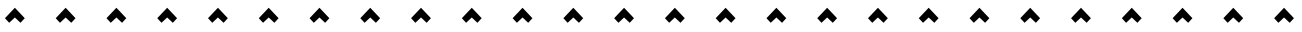

What do you look for when you plan a meeting or convention?

You need the right facilities to accommodate your group. You want comfortable, convenient lodgings, great food, and courteous service, with plenty of activities and attractions that offer one good time after another.

LOCATION

Jackson is an exciting, attractive city at the very heart of the Deep South, conveniently located in central Mississippi on an axis that runs from Chicago to New Orleans, from Atlanta to Dallas.

ACCOMMODATIONS & FACILITIES

The convention and meeting facilities in Jackson are second to none! There's an abundance of exhibit space, meeting facilities, and banquet seating. And with nearly 5,000 first-class hotel/motel rooms, there's always a comfortable, convenient place to stay.

RESTAURANTS

The South is known for its fine cuisine, drawn from the tables of the world and interpreted by culinary masters with a Southern flair. Over 300 Jackson restaurants serve a heaping helping of this authentic Southern fare, along with varied international dishes. Many offer convention and banquet facilities.

ATTRACTIONS

When there's free time between or after meetings, Jackson has quite a variety of sights and attractions to please even the most discerning conventioneer. We can suggest scenic tours or help plan special activities for your group at any number of interesting sites in and around our city.

SERVICE & SUPPORT

Jackson is the City with Soul, and you'll find out why when you experience it! The Jackson Convention and Visitors Bureau is committed to ensuring your meeting is a success. Our staff can assist you with every stage of planning, from canvassing available and affordable hotel accommodations to registration and program coordination. So, see the sights, taste the food, hear the music, live the events and sleep in comfort and style. You'll get a good Jackson feeling down in your soul.

Call us today at 1-800-354-7695 or 601-960-1891. We'll be happy to answer any questions you may have and work with you to tailor a custom meeting package especially for your group.

GENERAL FACTS

TAXES

7% sales tax; 4% hotel & 2% restaurant tax.
\$0.75 per night room tax

POPULATION

City Population 176,614
Metrowide Population 529,456

CLIMATE

Winter: 48°, Spring: 65°, Summer: 81°, Fall: 66°

LOCATION

Central Mississippi, Crossroads of
Interstates 55 and 20, running north-south and
east-west respectively.

HOTELS

49 properties, 5,000 rooms.

RESTAURANTS

Over 300 fine restaurants, many with convention and
banquet rooms; cuisine from authentic deep Southern
cooking to international fare.

WEB SITE

www.visitjackson.com

MAXIMUM CAPACITIES:

110,000 square feet of exhibit space in one facility; seating
capacity for 10,000 and dining capacities up to 2,800 at a
single event.

AVERAGE TEMPERATURES

	Daily High	Daily Low	Monthly Mean
JAN	50.8	35.8	47.1
FEB	61.7	37.8	49.8
MAR	68.7	43.4	56.1
APR	78.2	53.1	65.7
MAY	85.0	60.4	72.7
JUNE	91.0	67.7	79.4
JULY	92.7	70.6	81.7
AUG	92.6	69.8	81.2
SEPT	88.0	44.0	76.0
OCT	80.1	51.5	65.8
NOV	68.5	42.0	55.3
DEC	60.5	37.3	48.9

0° Days - 0, Freezing Days - 47, 90° Days - 78

*Source: Richard Boyer and David Savageau, Places
Rated Almanac (Your Guide to Finding the Best
Places to Live in America).*

spared the torch. It was rumored that Sherman bypassed the building because it housed a Masonic Lodge and that the Union Leader was himself a Mason. More likely its use as a hospital was the reason the building was not burned.

Although less than 8,000 people lived in Jackson at the turn of the century, its population began accelerating rapidly after 1900, and it is now one of the dynamic growth cities of the Sunbelt. In 2006, the population had climbed to more than 175,000 and the metropolitan area rose to better than 500,000. It is a major distribution center with a prime location of equal distance between Memphis and New Orleans (north-south), and between Dallas and Atlanta (east-west). Government – representing city, county, state, and federal agencies – is the city's largest employer.

As a major distribution center, efficient transportation facilities are a must. Major air carriers are located in the Jackson-Evers International Airport. The Canadian National/Illinois Central Railroad and the Kansas City Southern Railroad and scores of major truck lines provide freight service to all parts of the nation. Jackson boasts a regional shopping mall and several smaller, multi-store centers. Six hospitals, including the nationally renowned University of Mississippi Medical Center, provide diagnosis and treatment for nearly every possible physical and emotional ailment.

Every major religious faith is represented in the city, and there are more than 400 houses of worship scattered throughout the 105 square miles of community. An excellent public school system is an integral part of the city proper, as well as several private and parochial schools. Five colleges and three universities are located within 15 miles of the city's center.

Thousands of acres of public parks, formal and informal gardens, a nationally famous zoo, neighborhood playgrounds, and baseball, football, tennis, and soccer fields provide recreational outlets for all Jackson citizens. Outdoor living is paramount and all types of activities are available. Jogging and bike routes, nature trails, tennis centers, public and private golf courses, swimming pools and health clubs abound. The 50-square-mile Ross Barnett Reservoir, 12 miles northeast of the city center, is a haven for skiers, fishermen, campers, swimmers, and boating enthusiasts.

Residents are extremely proud of their famed Southern hospitality and outstanding quality of life. Community support is strong for a symphony orchestra, ballet company, an opera company, numerous theater groups, and world-class performances presented by local arts organizations.

Every four years, Jackson hosts the official USA International Ballet Competition at beautiful Thalia Mara Hall. The Mississippi Arts District also includes the International Museum of Muslim Cultures, the Russell C. Davis Planetarium, and the Mississippi Museum of Art.

Gourmet dining and nightlife sparkle on the Jackson scene. Many cultures and ethnic groups provide the city with cuisine that is truly international. One can choose from many different styles including Greek, Caribbean, Continental, Italian, Chinese, Japanese, Mexican, or good old Southern style.

With a rich history, convenient transportation, thriving cultural community and international cuisine, Jackson provides entertainment and Southern hospitality only found in the City with Soul.

TRANSPORTATION

AIR

Jackson-Evers International Airport
100 International Drive • 601-939-5631
www.jmaa.com

Jackson-Evers International Airport is the commercial airport serving Jackson. Designated as a general purpose Foreign Trade Zone, it maintains two 8,500-foot runways and has undergone a multi-million dollar renovation.

American Eagle
www.americanair.com • 800-433-7300

Continental Express
www.continental.com • 800-523-3273

Delta Airlines
www.delta.com • 800-221-1212

Southwest
www.southwest.com • 800-435-9792

US Airways Express
www.usair.com • 800-428-4322

DAILY DIRECT FLIGHTS SERVING JACKSON

- Atlanta
- Baltimore/Washington D.C.
- Charlotte
- Chicago-Midway
- Dallas/Ft. Worth
- Houston – Hobby
- Houston – Bush Intercontinental
- Memphis
- Orlando
- Washington D.C. Reagan

UNION STATION

Multimodal rail and bus depot
300 W. Capitol St. • 601-355-6350

RAIL

Amtrak Passenger Station
General Information and Reservations
www.amtrak.com • 1-800-872-7245

Amtrak serves the city of Jackson with daily service to Chicago and New Orleans.

BUS

Greyhound-Trailways Bus Lines
www.greyhound.com • 601-354-1913

Provides 8 inbound and outbound buses daily.

LIMO, TAXI CAB & LOCAL CHARTER BUS

Information is available by contacting our Convention Services Manager at 601-960-1891.

GROUND DISTANCES TO MAJOR CITIES

- Atlanta 441
- Birmingham 248
- Chicago 753
- Dallas 412
- Memphis 208
- Miami 979
- New Orleans 185
- St. Louis 505

GROUND DISTANCES TO OTHER MISSISSIPPI CITIES

- Biloxi 165
- Brookhaven 56
- Clarksdale 151
- Cleveland 127
- Columbus 147
- Corinth 218
- Greenville 115
- Greenwood 96
- Grenada 113
- Gulfport 157
- Hattiesburg 88
- Laurel 84
- Meridian 93
- Moss Point 181
- Natchez 102
- Oxford 165
- Pascagoula 184
- Southaven 198
- Starkville 125
- Tupelo 170
- Vicksburg 44
- Yazoo City 44



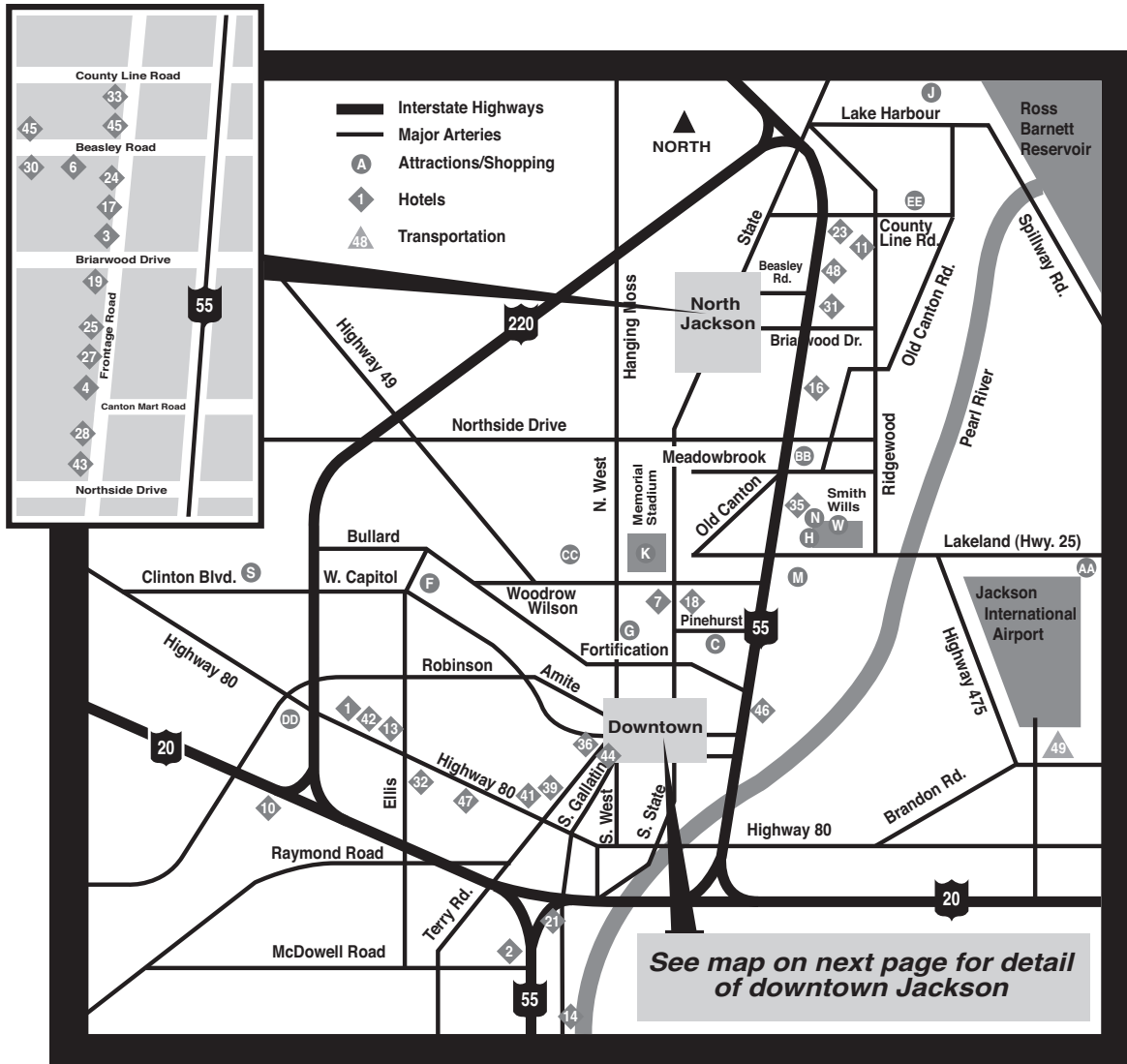

JACKSON ATTRACTIONS, SHOPPING, & HOTELS

Attractions*

- A. City Hall*
- B. Davis Planetarium*
- C. Eudora Welty House & Garden
- D. Governor's Mansion*
- E. Jackson Convention Complex*
- F. Jackson Zoological Park
- G. Manship House
- H. Mississippi Agriculture & Forestry Museum
- I. Mississippi Arts Center*
- J. Mississippi Crafts Center
- K. Mississippi Veterans Memorial Stadium
- L. Mississippi Museum of Art*
- M. Mississippi Museum of Natural Science
- N. Mississippi Sports Hall of Fame & Museum
- O. Mississippi State Capitol*
- P. Mississippi State Coliseum*
- Q. Mississippi State Fairgrounds*
- R. Mississippi Trade Mart*
- S. Mynelle Gardens
- T. The Oaks House Museum*
- U. Old Capitol Museum*

- V. Smith Robertson Museum*
- W. Smith-Wills Stadium
- X. Thalia Mara Hall*
- Y. War Memorial Building*
- Z. William F. Winter Archives Building*

Shopping*

- AA. Dogwood Festival Market
- BB. Highland Village
- CC. Jackson Medical Mall
- DD. Metrocenter Mall
- EE. Northpark Mall

Hotels*

1. America's Best Inn
2. America's Best Value Inn
3. Baymont Inn
4. Best Value Inn & Suites
5. Best Western Executive Inn*
6. Best Western Jackson North
7. Cabot Lodge Millsaps
8. Clarion Hotel, The Roberts Walthall*
9. Coliseum Inn & Suites*
10. Comfort Inn Southwest

11. Courtyard by Marriott
12. Days Inn-Coliseum*
13. Days Inn Southwest
14. E.com Lodge
15. Extended Stay Deluxe
16. Extended Stay of America
17. Fairfield Inn by Marriott
18. Fairview Inn (Bed & Breakfast)
19. Hampton Inn North
20. Hampton Inn & Suites*
21. Hill Top Inn
22. Hilton Garden Inn Jackson/Downtown (formerly the Historic King Edward Hotel)*
23. Hilton Jackson
24. In-Town Suites
25. Inns of USA
26. Jackson Express*
27. Jackson Inn
28. Jackson Inn and Suites
29. Jackson Marriott-Downtown*
30. Jameson Inn
31. La Quinta Inn North
32. Metro Inn
33. Motel 6

34. Old Capitol Inn (Boutique Hotel)*
35. Parkside Inn
36. Poindexter Park Inn (Bed & Breakfast)
37. Quality Inn*
38. Red Roof Inn Fairgrounds*
39. Regal Inn
40. Regency Hotel & Convention Center*
41. Regency Inn
42. Scottish Inn
43. Select 10 Motel North
44. Sleep Inn & Suites*
45. Studio 6
46. Studio 6
47. Super 8
48. Super 8 North

Transportation*

49. Jackson-Evers International Airport
50. Union Station*

*See downtown map opposite for detail

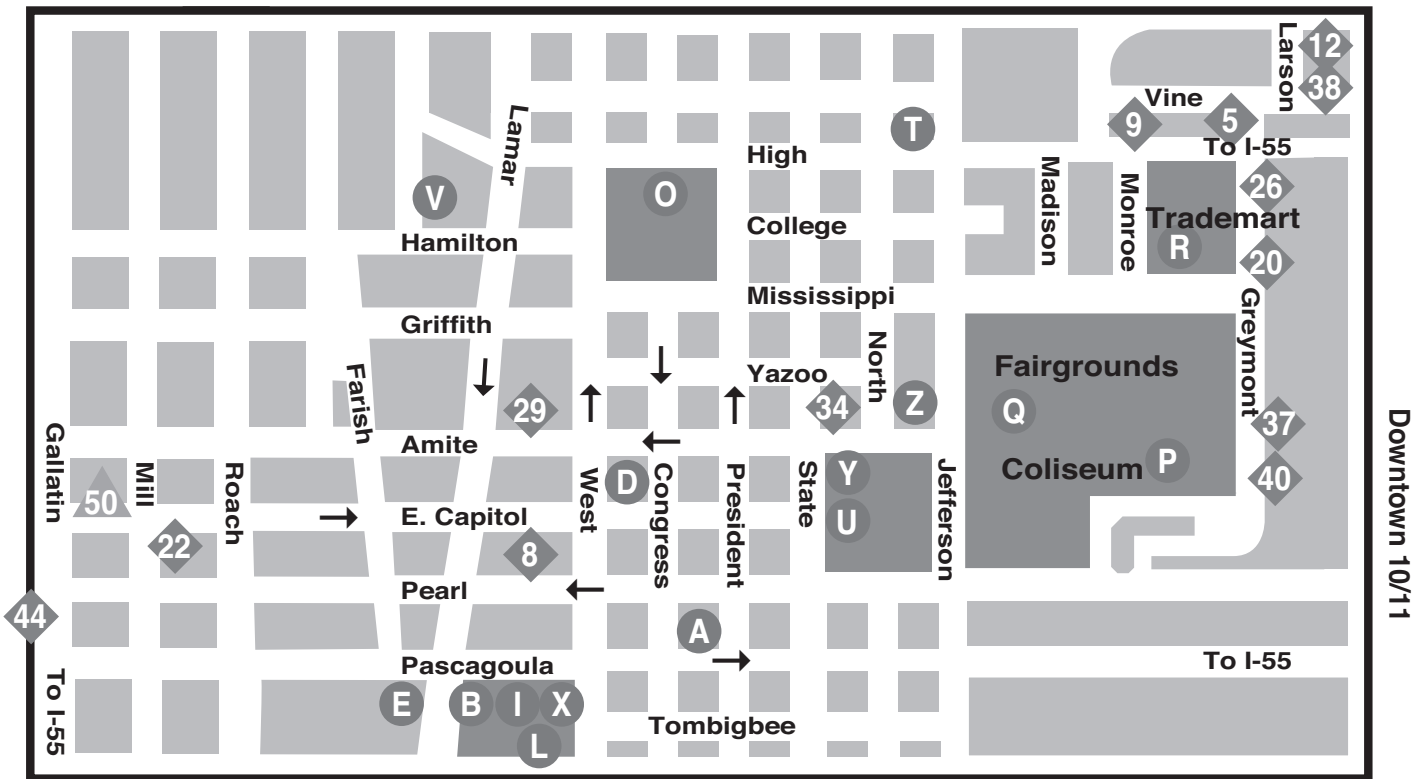

● DOWNTOWN ATTRACTIONS**

- A. City Hall
- B. Davis Planetarium
- D. Governor's Mansion
- E. Jackson Convention Complex
- I. Mississippi Arts Center
- L. Mississippi Museum of Art
- O. Mississippi State Capitol
- P. Mississippi State Coliseum
- Q. Mississippi State Fairgrounds
- R. Mississippi Trade Mart
- T. The Oaks House Museum
- U. Old Capitol Museum
- V. Smith Robertson Museum & Cultural Center
- X. Thalia Mara Hall
- Y. War Memorial Building
- Z. William F. Winter Archives Building

◆ DOWNTOWN HOTELS**

- 5. Best Western Executive Inn
- 8. Clarion Hotel, The Roberts Walthall
- 9. Coliseum Inn & Suites
- 12. Days Inn - Coliseum
- 20. Hampton Inn & Suites
- 22. Hilton Garden Inn Jackson/Downtown (formerly the Historic King Edward Hotel)
- 26. Jackson Express
- 29. Jackson Marriott - Downtown
- 34. Old Capitol Inn
- 37. Quality Inn
- 38. Red Roof Inn Fairgrounds
- 40. Regency Hotel & Convention Center
- 44. Sleep Inn & Suites

▲ TRANSPORTATION**

- 50. Union Station

**See listings on previous page

BUREAU SERVICES



Invitation

An official invitation is extended to your association. The invitation packet includes letters from the Governor, Mayor, the Convention & Visitors Bureau, area attractions and businesses. An audio/visual presentation on Jackson is also available.



Hotels, Motels & Restaurants

The Bureau will canvass local hotels/motels for available space, rates, accommodations and dates for your meeting.



Program Coordination

The Bureau can put you in touch with the right people to coordinate your convention program, prepare a tour, or organize a spouse's or children's program, and take care of your transportation needs.



Attendance Promotion

The Bureau will provide attendance promotion materials for your registration packets. These include area interest pamphlets, hotel and restaurant information, maps and tour guide brochures.



Publicity

The Bureau will distribute one news release on your behalf to the media. Also available are photographs and printed materials of Jackson for use in preparing your organization's publications.



Welcome

Allow us to welcome your convention delegates to our city. Warm greetings are available for the opening of your convention ceremonies.



Registration

Registration assistants are available with laptop computers and printers to service your conference on site. Other equipment, such as audio/visual devices, is available through local rental agencies. Preprinted computer-generated name badges for your delegates can be provided by the Bureau with a minimum of three weeks notice. Preprinted ribbons are also available to identify key convention staff and guests. Personnel are available through the Bureau to act as registration assistants, tour guides, hostesses, or ushers.



Brochures

Visitor information brochures are available for mailing or for convention registration desks. Specific attraction brochures are provided upon request and availability.

JACKSON CONVENTION COMPLEX

Lamar Street & Pascagoula Street

Downtown Jackson

601-960-2321

FAX 601-960-2584

www.jacksonconventioncomplex.com

The Jackson Convention Complex is 330,000 square feet of pure possibility. With so much state-of-the-art ballroom, exhibit and meeting space at your command, you'll be able to host practically anything you can imagine, from sports tournaments, consumer expos and trade shows to regional and national conventions.

Located in the very center of a city filled with passion, warmth, and heart, the new Jackson Convention Complex is where Mississippi meets the world.

- Total Site Square Footage: 330,000
85,000 square feet of divisible space
60,000-square-foot exhibit hall, divisible into 2
25,000-square-foot ballroom, divisible into 5
33,000 square feet of lobbies, concourse, and registration areas
- Crystalline folding glass facade
- Separate entrances for exhibit hall and ballroom
- Covered bus and vehicular drop-off lanes
- State-of-the-art telecommunications and audio-visual
- 10,000-square-foot kitchen with separate load-in dock
- Two full-service concession areas in exhibit hall
- Storage, security, and first-aid areas
- Fenced staging and load-in dock area
- Separate ballroom entrance from Lamar Street
- Movable wall divider system in exhibit hall and ballroom
- Savor Jackson catering by SMG
- Separate truck entrance and exit
- Utility floor boxes with telecommunications, electricity, air, water, plumbing
- Easily accessible freight elevators
- Ballroom and exhibit hall rigging points
- Plasma screen monitors and electronic directional signage throughout
- CAT 5 wiring and communication data ports throughout
- Two types of floors – sealed concrete in exhibit hall, carpet throughout ballroom, meeting rooms, and prefunction area
- Acoustic wall panels in exhibit hall
- Dual loading docks and ramps with 20' x 20' roll-up doors each
- 40,000-square-foot sports court

JACKSON CONVENTION COMPLEX

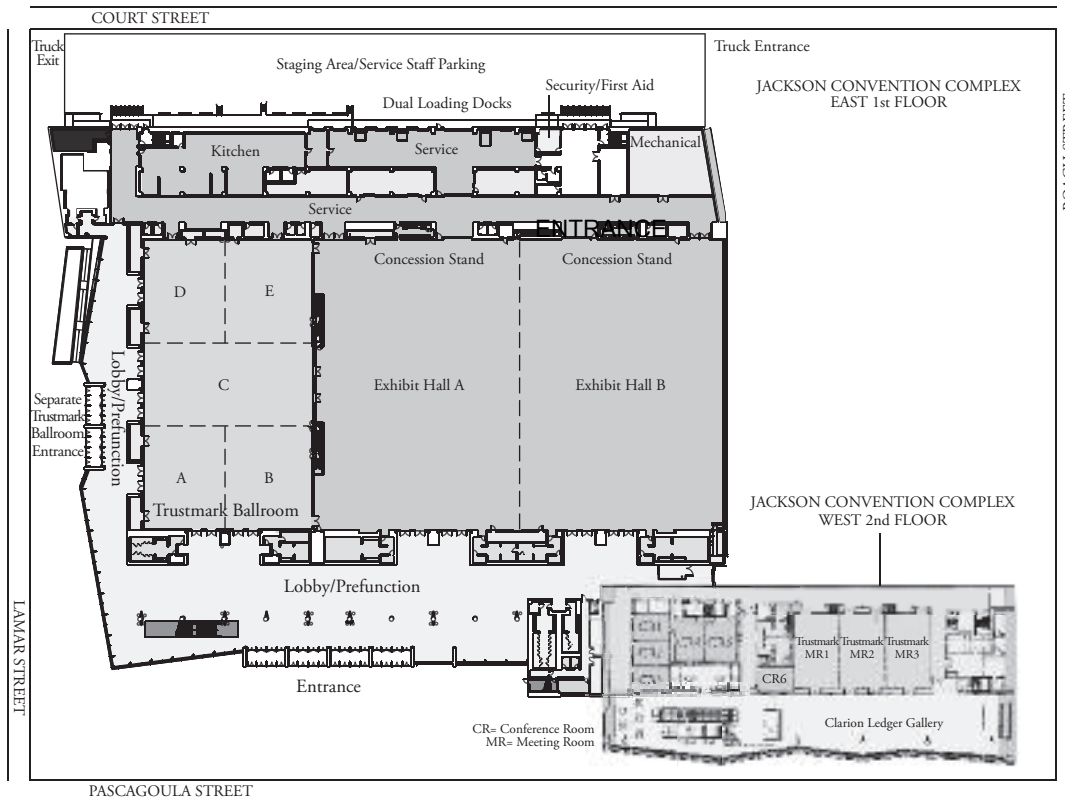

Jackson Convention Complex East

Room	Sq. Ft.	Banquet	Theatre	Classroom	Reception	10x10 Exhibits
Exhibit Hall A and B combined with Ballroom	.85,000	-	-	-	.6,800-7,000	.425
Exhibit Hall A and B	.60,000	.3,400	.5,000-5,150	.2,400-2,600	.5,200-5,400	.305
Exhibit Hall A	.30,000	.1,600	.2,200-2,400	.1,000-1,115	.2,600-2,800	.150
Exhibit Hall B	.30,000	.1,700	.2,300-2,550	.1,200-1,300	.2,600-2,800	.170
Trustmark Ballroom	.25,000	.1,500	.1,950-2,150	.1,000-1,075	.2,300-2,500	.125
Ballroom A-B-C	.16,800	.900	.1,350-1,550	.450-525	.2,000-2,400	.80
Ballroom C-D-E	.16,800	.900	.1,350-1,550	.450-525	.2,000-2,400	.80
Ballroom A-B	.8,400	.490	.700-825	.325-365	.1,000-1,200	
Ballroom C	.8,400	.400	.600-725	.290-320	.1,000-1,200	
Ballroom D-E	.8,400	.490	.700-825	.325-365	.1,000-1,200	
Ballroom A	.4,200	.240	.350-415	.120-160	.400-425	
Ballroom B	.4,200	.240	.350-415	.120-160	.400-425	
Ballroom C	.8,400	.400	.600-725	.290-320	.1,000-1,200	
Ballroom D	.4,200	.240	.350-415	.120-160	.400-425	
Ballroom E	.4,200	.240	.350-415	.120-160	.400-425	
Meeting Room 1	.1,000	.60	.100-110	.30-40	.120	
Meeting Room 2	.1,000	.60	.100-110	.30-40	.120	
Meeting Room 3	.1,000	.60	.100-110	.30-40	.120	
Meeting Room 4	.1,000	.60	.100-110	.30-40	.120	
Meeting Room 5	.1,000	.60	.100-110	.30-40	.120	
Meeting Room 6	.1,000	.60	.100-110	.30-40	.120	
Meeting Room 7	.1,000	.60	.100-110	.30-40	.120	
Meeting Room 8	.1,000	.60	.100-110	.30-40	.120	
Meeting Room 9	.1,000	.60	.100-110	.30-40	.120	
Meeting Room 10	.1,000	.60	.100-110	.30-40	.120	
Pre-Function Lobby and Registration Space	.33,000				.1,500-2,000	.77
Board Room A	.Permanent set-up for 20					
Board Room B	.Permanent set-up for 20					

JACKSON CONVENTION COMPLEX

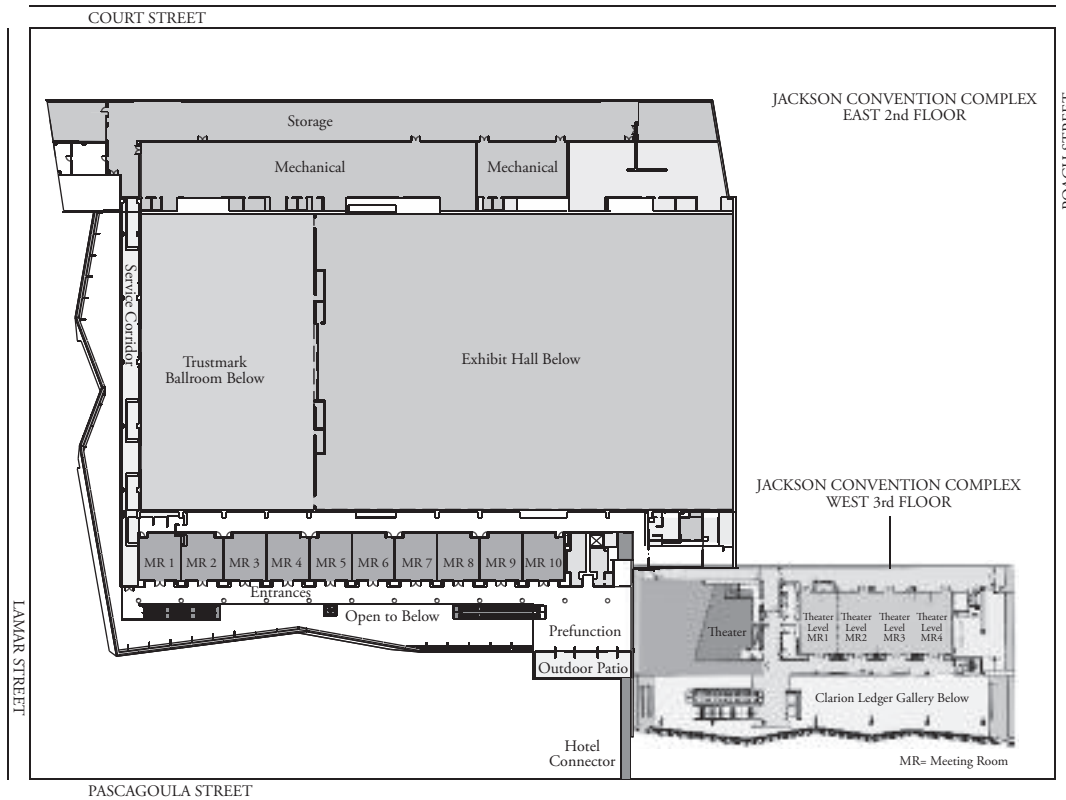

Jackson Convention Complex West

Room	Sq. Ft.	Banquet	Theatre	Classroom	Reception	10x10 Exhibits
Trustmark Meeting Rooms						
Meeting Rooms 1, 2 & 3	4,779	280-300	425	200-225	450	24
Meeting Rooms 1 & 2	3,186	180-200	325	180	325	16
Meeting Rooms 2 & 3	3,186	180-200	325	180	325	16
Meeting Room 1	1,566	80-100	160	80	160	9
Meeting Room 2	1,620	80-100	170	80	170	9
Meeting Room 3	1,566	80-100	160	80	160	9
Conference Rooms						
Conference Room 1	432	30	35	22	35	
Conference Room 2	432	30	35	22	35	
Conference Room 3	432	30	35	22	35	
Conference Room 4	560	50	50	30	50	
Conference Room 5	560	50	50	30	50	
Conference Room 6	432	30	35	22	35	
The Clarion-Ledger Gallery	5,760	320-400	525	240-260	525	26
Meeting Rooms						
Meeting Rooms 1, 2, 3 & 4	5,046	300-320	475	225-240	475	24
Meeting Rooms 1 & 2	2,523	160-180	260	125	260	12
Meeting Rooms 3 & 4	2,523	160-180	260	125	260	12
Meeting Room 1	1,261	70-90	140	60	150	7
Meeting Room 2	1,261	70-90	140	60	150	7
Meeting Room 3	1,261	70-90	140	60	150	7
Meeting Room 4	1,261	70-90	140	60	150	7
Theater			382			

Room capability numbers are for general reference only. They are based on maximum seating without space allowance for head tables, staging/risers, audio/visual or other equipment.

CABOT LODGE MILLSAPS

2375 North State Street
 601-948-8650 • 1-800-874-4737
 FAX 601-948-8650 Ext. 198

Number of Rooms: 205
Location: Conveniently located 1 mile from I-55 at the intersections of Jackson's medical community. Easy access to downtown.
Guest Services: Complimentary deluxe continental breakfast, evening complimentary cocktails. Pool, laundry, fitness room, free high-speed wireless Internet connection, free local calls, 24-hour coffee. Fax service (free incoming).
Handicap Accessible: Meets all the newest ADA requirements.

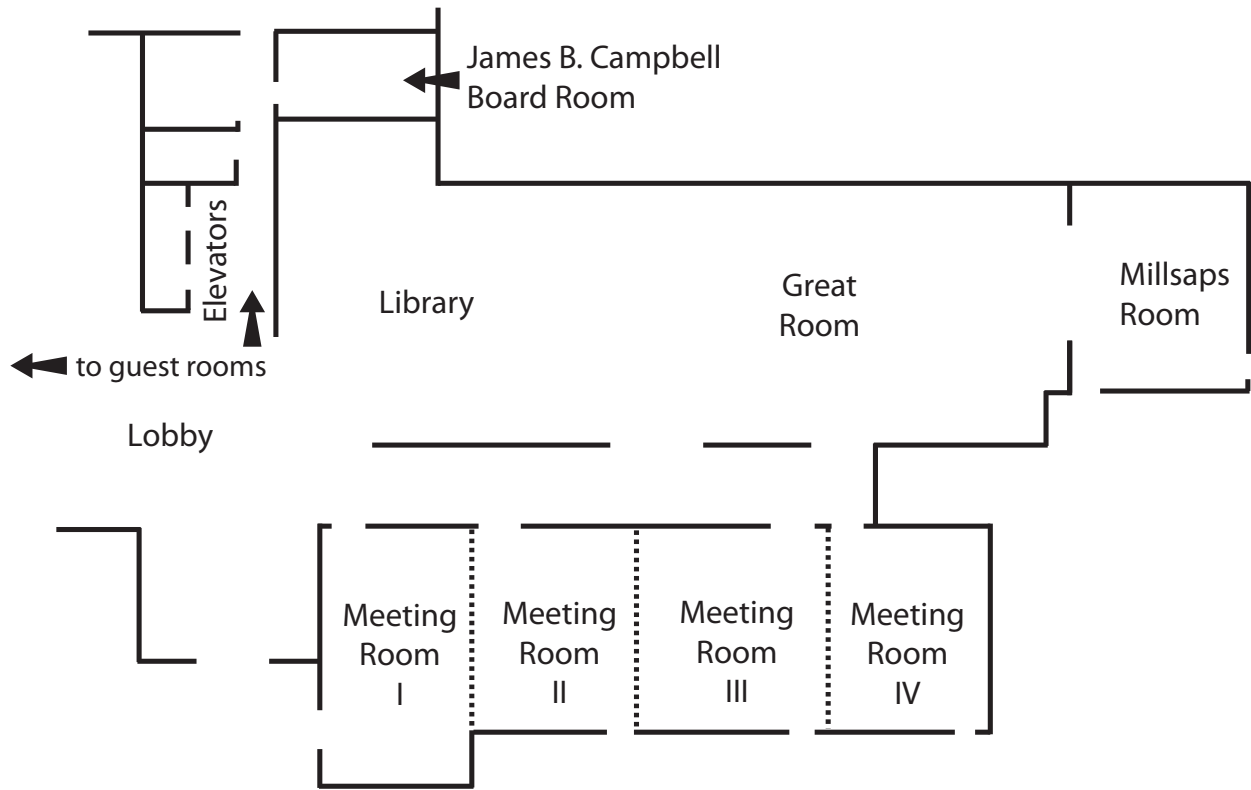

Room Name	Sq. Ft.	Theatre	Classroom	Banquet	Cocktails
Meeting Room					
All 4 combined	3300	300	168	350	450
3-room combination	2400	225	126	225	350
2-room combination	1600	150	84	150	200/225
1 room	800	75	42	60	100
Millsaps Room	837	75	40	75	85
James B. Campbell Board Room	275	permanently set conference style for 14			

CLARION HOTEL & SUITES NORTH

5075 I-55 North
 601-366-9411
 1-800-611-9151
 FAX 601-366-6688

Number of Rooms: 222 rooms, including 30 suites
Location: I-55 North. From I-55 take Briarwood Drive exit #102.
Restaurant: Rhino's
Guest Services: Cable TV, swimming pool, laundry facilities, newspaper, vending machines and room service. All rooms and suites: executive desk, computer port, extra telephones, voice mail, data ports, complimentary iron and ironing boards, coffee pots, make-up mirrors, and complimentary airport shuttle service.
Handicap Accessible

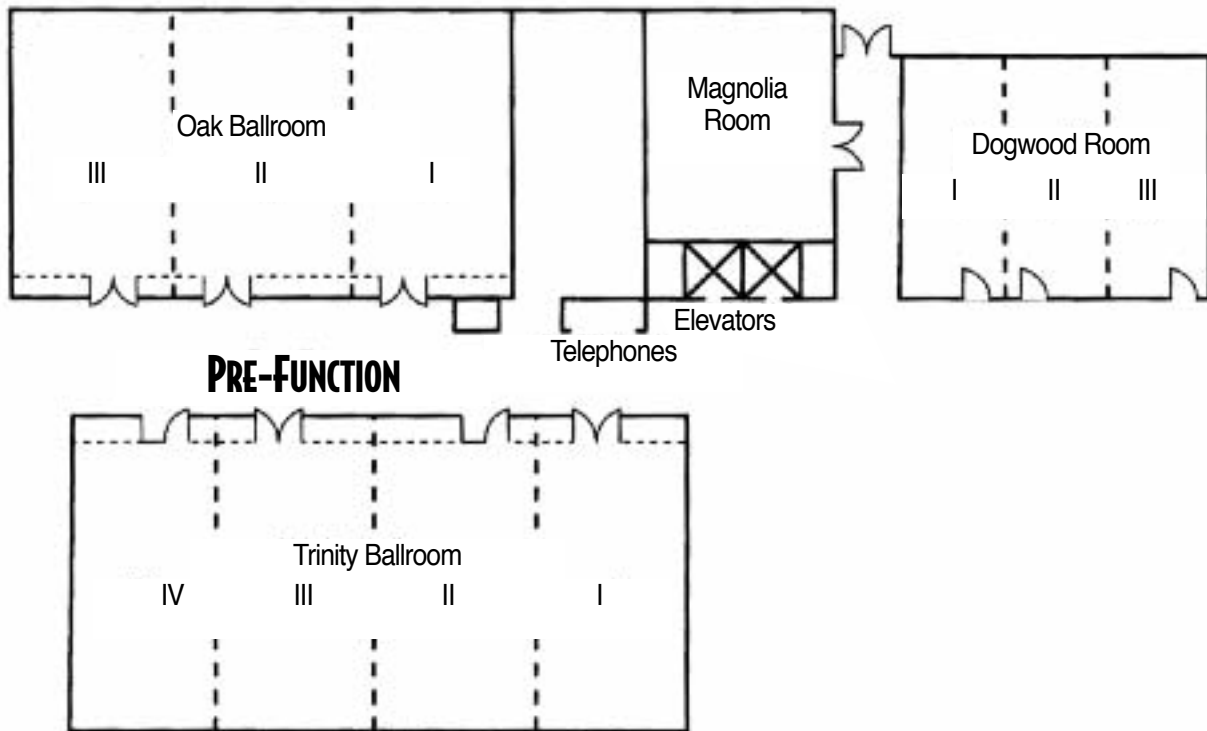

Room Name	Dimensions	Sq. Ft.	Ceiling	Banquet	Reception	Theatre	Classroom
Trinity Ballroom	94' x 40'	3760	12'	320	430	370	230
I	23' x 40'	920	12'	80	105	90	55
II	25' x 40'	1000	12'	80	110	100	60
III	25' x 40'	1000	12'	80	110	100	60
IV	21' x 40'	840	12'	70	100	85	50
Oak Ballroom	70' x 26'	1820	10'	150	205	185	110
I	25' x 26'	650	10'	55	70	65	40
II	25' x 26'	650	10'	55	70	65	40
III	20' x 26'	520	10'	45	60	50	30
Dogwood Room	36' x 29'	1044	11'	85	120	105	65
I	12' x 29'	348	11'	30	40	35	20
II	12' x 29'	348	11'	30	40	35	20
III	12' x 29'	348	11'	30	40	35	20
Magnolia Room	27' x 36'	972	8'	80	110	95	60
Pre-function	—	2380	—	—	270	—	—

CLARION HOTEL, THE ROBERTS WALTHALL

225 East Capitol Street
 601-948-6161 • 1-800-932-6161
 Fax 601-948-0088

Number of Rooms: 208
 Location: Exit Pearl Street off Interstate 55 in downtown Jackson.
 Restaurant: "The Cafe"
 Lounge: "The Cafe" Piano Bar
 Guest Services: Room service, same-day valet, gift shop, barbershop, complimentary van, security-monitored parking garage free to hotel guests, complete recreation center with heated swimming pool, jacuzzi and fitness center, high-speed Internet in all rooms.

EIGHTH FLOOR

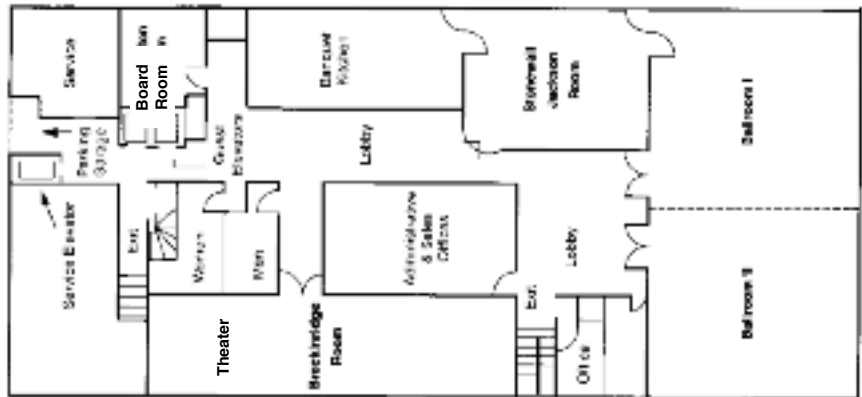

SECOND FLOOR

Room Name	Dimensions	Banquet	Classroom	Theatre	Reception	Sq. Ft.
2nd floor						
Ballroom #1	35' x 38'6"	130	97	200	200	1348
Ballroom #2	33' x 38'6"	125	94	190	190	1270
Ballroom combined	38'6" x 68'	250	190	400	400	2618
Stonewall Jackson	26'6" x 34'	80	60	120	120	900
Theater	16'6" x 68'	75	60	100	100	1122
Board	16' x 18'	14	14	20	20	300
8th floor						
Camellia	23' x 33'	64	48	96	96	750
Magnolia	22' x 24'	45	33	67	67	540
Azalea	21' x 24'	40	30	60	60	460
Dogwood	15' x 35'	45	33	67	67	540

HILTON GARDEN INN JACKSON/DOWNTOWN

Formerly the Historic King Edward Hotel



235 West Capitol Street
 601-353-5464
 1-800-HILTONS
 FAX 601-353-5465
www.jacksondowntown.hgi.com

Number of Rooms: 186
 Restaurant: On property
 Lounge: On property
 Guest Services: Room service, indoor pool, hot tub, exercise facility, laundry/dry cleaning, business center, high-speed/broadband/wireless free to hotel guests, coffeemaker, microwave, refrigerator, safe/lock box for a fee, group rate/discount.
 Handicap Accessible

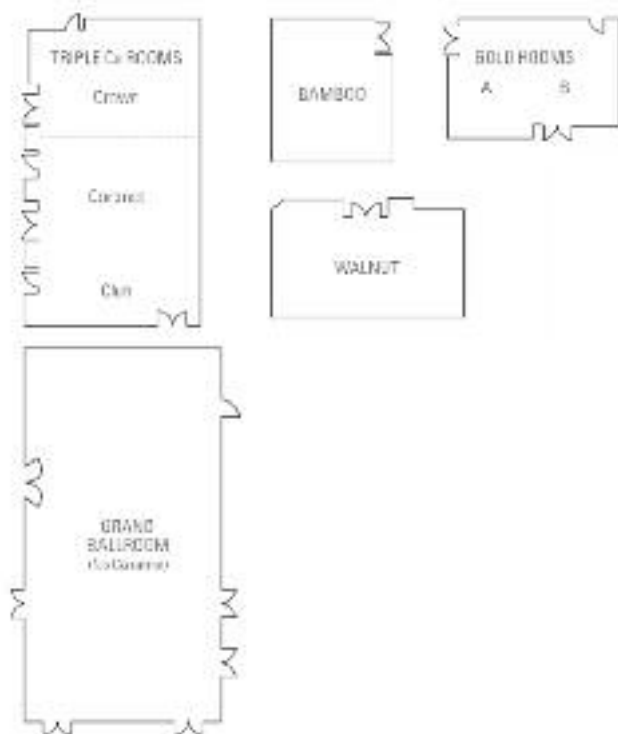

Room	Sq.Ft.	Dimensions	Theater	Classroom	H-square	Conference	Reception	Banquet B	Banquet 10
Grand Ballroom	3120	.78x40x10'	304	180	-	-	325	168	210
Triple C's Rooms	1846	.32x58x10'	179	-	-	-	263	72	90
Club	416	.32x13x10'	29	15	12	24	59	16	20
Coronet	800	.32x25x10'	34	33	18	24	114	32	40
Crown	630	.32x20x10'	33	18	12	24	90	16	20
Gold Rooms	682	.31x22x10'	48	30	18	24	97	40	45
Gold A	308	.14x22x10'	12	9	12	12	44	16	20
Gold B	374	.17x22x10'	30	24	18	12	53	24	30
Bamboo	532	.19x28x10'	29	15	18	18	45	32	40
Walnut	741	.19x39x10'	56	36	30	30	61	24	30
Boardroom	390	.13x30x11'	-	-	-	-	16	-	-

HILTON JACKSON

1001 County Line Road
 601-957-2800 • 1-888-263-0524
 FAX 601-978-2242

Number of Rooms: 273
 Location: I-55 North at County Line Road
 Restaurant: Dining Room/Huntington's Grille
 Lounge: Piano bar

Guest Services: Club level with concierge service, complimentary hors d'oeuvres and continental breakfast, gift shop, Brass Shears barber shop, room service, courtyard pool with jacuzzi, jogging area, florist center, and laundry service. Complimentary airport shuttle, on-site limousine service, business center, data phones, full-time concierge, and fitness center.

Handicap Accessible

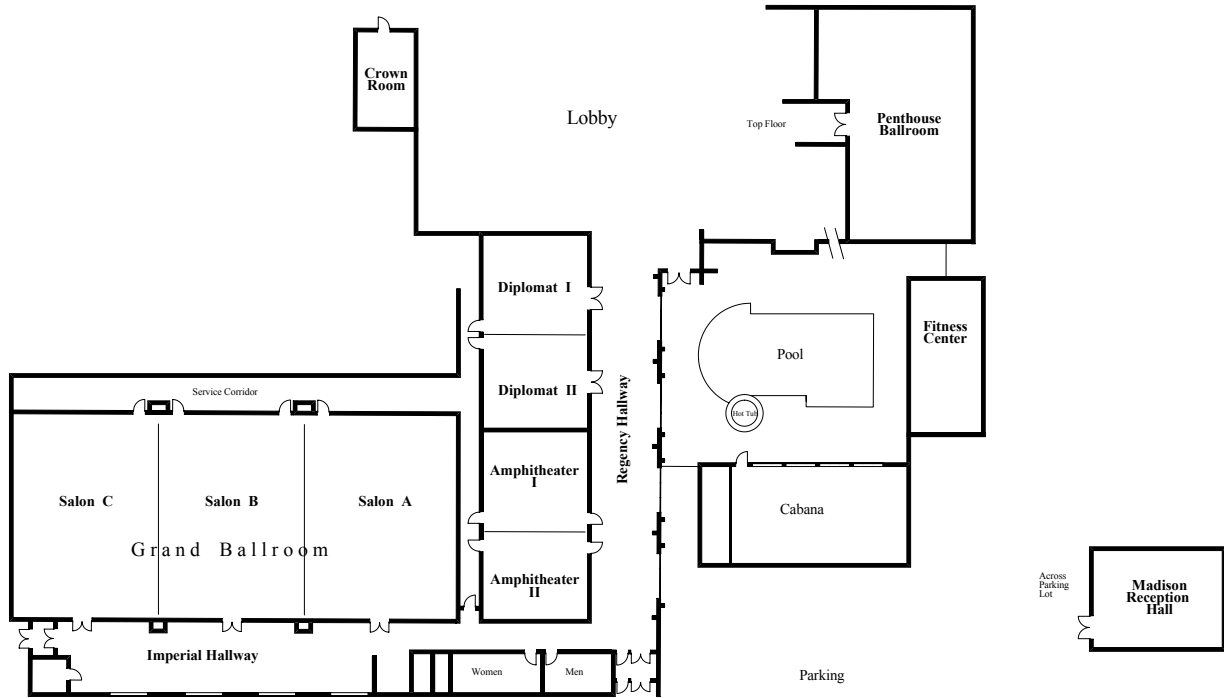

Room	Dimensions	Sq. Ft.	Reception	Theatre	Chevron	Rounds	Banquet	Conference	Classroom	U-Shape	
						8	10				
Grand Ballroom	135' x 60'	8100	1200	1200	900	528	660	800	210	540	180
Each Salon	60' x 45'	2700	400	330	150	176	220	280	70	180	60
Regency Hall	100' x 20'	2000	—	—	—	—	—	—	—	—	—
Imperial Hall	108' x 20'	2160	—	—	—	—	—	—	—	—	—
Amphytheaters	54' x 32'	1728	—	—	—	—	—	—	—	110	—
Amphytheater I	28' x 32'	896	—	—	—	—	—	—	—	60	—
Amphytheater II	26' x 32'	832	—	—	—	—	—	—	—	50	—
Diplomats	56' x 32'	1792	150	200	90	96	120	160	60	100	50
Diplomat I	28' x 32'	896	75	100	42	48	60	80	30	50	25
Diplomat II	28' x 32'	896	75	100	42	48	60	80	30	50	25
Crown Room	36' x 18'	648	45	50	25	32	40	50	25	30	20
The Cabana	47' x 26'	1222	100	150	60	56	70	78	48	70	35
Penthouse	64' x 36'	2304	200	150	100	80	100	160	60	120	50
Port Gibson	26' x 24'	672	30	25-30	—	—	—	—	16	12	—
Board Rooms (4)	—	—	25	25-30	—	—	—	—	10	—	—
Madison Reception Hall	—	—	200	100	50	120	150	100	30	60	25

JACKSON MARRIOTT - DOWNTOWN

200 East Amite Street
601-969-5100
FAX 601-969-9665

Number of Rooms: 303, 3 suites
Location: In the heart of downtown Jackson
Restaurant: Bistro 200
Lounge: Bistro Lounge
Guest Services: Complimentary amenities, wake-up call, valet service, guest laundry, room service, voice mail, swimming pool, fitness center, secured garage parking, business center, gift shop, coffee pots, full-size iron and ironing board, data ports – two phones and two phone lines with data port. Microwaves and refrigerators available for a small fee.
High-speed Internet.
Handicap Accessible

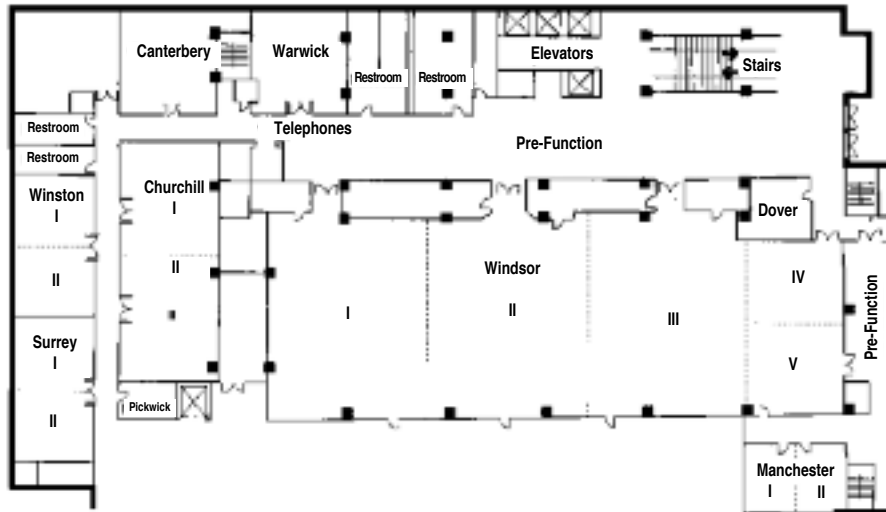

Room	Dimensions	Banquet	Reception	Theatre	Classroom	Ceiling	Sq. Ft.
Windsor Ballroom	.65' x 150'	.1000	.1400	.1200	.750	20'	.9750
Windsor Ballroom with							
IV and V	65' x 180'	1200	1600	1400	870	20'	11,342
I	50' x 65'	340	460	400	250	20'	3250
II	50' x 65'	340	460	400	250	20'	3250
III	50' x 65'	340	460	400	250	20'	3250
IV	22' x 30'	70	100	90	50	13'	700
V	29' x 30'	90	130	100	70	13'	892
Manchester	23' x 30'	70	100	90	50	12'	690
I	15' x 23'	40	50	40	30	12'	345
II	15' x 23'	40	50	40	30	12'	345
Warwick	30' x 32'	100	140	120	70	12'	960
Canterbury	30' x 32'	100	140	120	70	12'	960
Churchill	31' x 74'	240	330	290	180	12'	2294
I	31' x 38'	120	170	150	90	12'	1178
II	31' x 36'	120	160	140	90	12'	1116
Winston	26' x 44'	120	160	140	90	10'	1140
I	22' x 26'	60	80	70	40	10'	570
II	22' x 26'	60	80	70	40	10'	570
Surrey	26' x 44'	120	160	140	90	10'	1140
I	22' x 26'	60	80	70	40	10'	570
II	22' x 26'	60	80	70	40	10'	570
Briarwood (NS)	19' x 30'	50	80	80	40	—	570
Newbury (NS)	37' x 24'	90	130	100	70	—	888
Pre-function	—	—	75	—	—	—	5962
Oxford	.18' x 21'	40	50	40	20	10'	.278
Pickwick							.Boardroom for up to 10
Dover							.Boardroom for up to 12

REGENCY HOTEL & CONFERENCE CENTER

400 Greymont Avenue, Jackson, MS 39202

601-969-2141 • FAX 601-355-1704

Number of Rooms: 141

Restaurant: Garden Café Restaurant

Lounge: Emporium Lounge & Grill

Guest Services: One-day valet, satellite television, outdoor pool, room service, complimentary airport transportation, complimentary continental breakfast.

Handicap Accessible

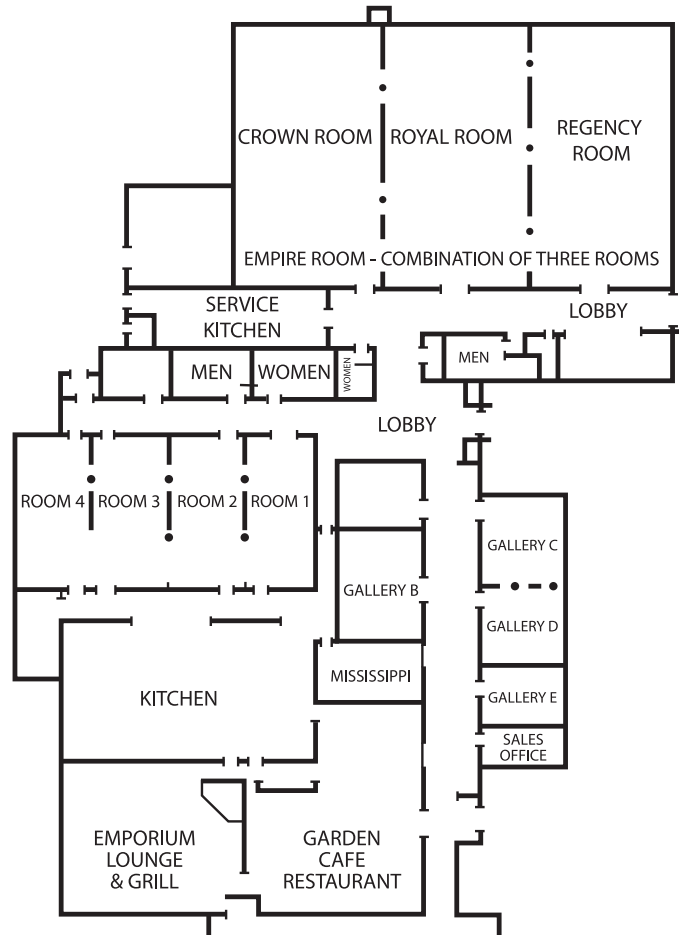

Room Name	Dimensions	Sq. Ft.	Theatre	Classroom	Reception	Banquet
Empire	82' x 120'	9840	1600	700	1600	1200
Crown	82' x 40'	3280	500	250	250	325
Royal	82' x 40'	3280	500	250	250	325
Regency	82' x 40'	3280	500	250	250	325
Room 1	22' x 40'	880	125	60	100	90
Room 2	22' x 40'	880	125	60	100	90
Room 3	22' x 40'	880	125	60	100	90
Room 4	22' x 40'	880	125	60	100	90
Mississippi	33' x 37'	1221	100	60	75	75
Gallery B	31' x 24'	744	60	35	50	40
Gallery C	26' x 24'	624	50	30	50	40
Gallery D	30' x 24'	720	50	35	50	40
Gallery E	26' x 24'	624	60	30	50	40

SELECT 10 MOTEL NORTH

4641 I-55 North
 601-982-1044
 1-800-800-8000
 FAX 601-982-1044

Number of Rooms: 88 (171 when combined with adjoining Knight's Inn)
 Location: I-55 North at Northside Drive – Frontage Road
 Guest Services: Swimming pool, complimentary morning coffee,
 FAX and copy service, free local calls, fitness center.
 Handicap Accessible

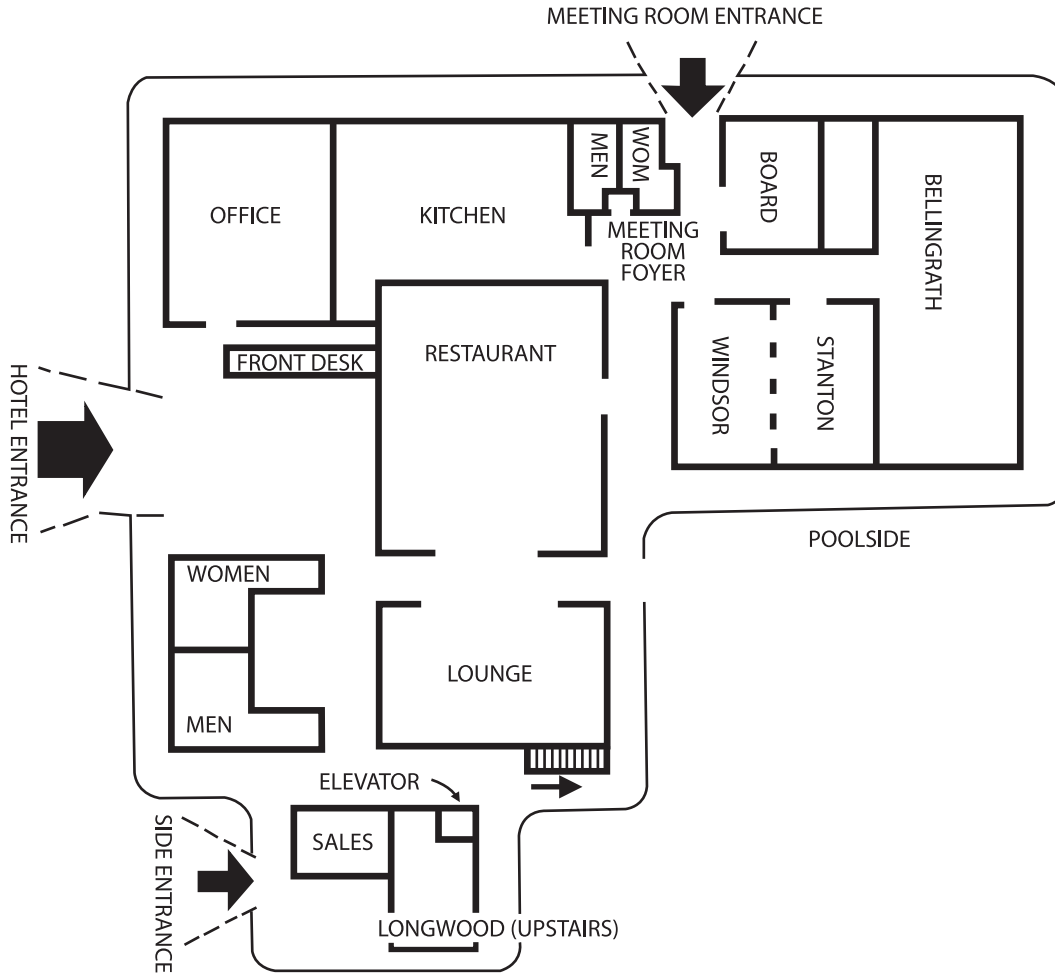

Room Name	Dimensions	Sq. Ft.	Outlets	Reception	Classroom	Conference	Banquet	Theatre
Windsor	20' x 25'	500	3	75	30	20	32	60
Stanton	19' x 25'	475	3	75	30	20	32	60
Combined	39' x 25'	975	6	150	60	20	70	120
Bellingrath	56' x 21'	1176	9	200	100	20	115	200
Board Room	20' x 20'	400	5	35	20	20	30	30
Longwood	20' x 20'	400	5	35	20	20	30	25
Executive Magnolia	20' x 20'	400	5	35	20	20	30	25

OTHER HOTEL ACCOMMODATIONS WITH MEETING SPACE

AMERICA'S BEST SUITES - 103 ROOMS

5411 I-55 N • 1-800-BEST-INN • 601-899-9000

Room Name	Dimensions	Sq. Ft.	Reception	Classroom	Conference	Banquet	Theatre
Room 1	24' x 50'	1200	100	75	—	50-75	100

BEST VALUE INN & SUITES - 120 ROOMS

5035 I-55 North • 1-800-528-1234 • 601-982-1011

Room Name	Dimensions	Sq. Ft.	Reception	Classroom	Conference	Banquet	Theatre
Magnolia	25' x 40'	1000	125	60	—	75	100
Dogwood	18' x 22'	396	35	25	—	32	100
Combined		1396	150	85	—	110	125
Executive Boardroom		420	35	25	—	32	35

COURTYARD BY MARRIOTT - 117 ROOMS

6820 Ridgewood Court • 1-800-321-2211 • 601-956-9991

Room Name	Dimensions	Sq. Ft.	Reception	Classroom	Conference	Banquet	Theatre
Room 1	—	624	45	25	25	—	45
Room 2	—	624	45	25	25	—	45

FAIRVIEW INN (BED & BREAKFAST) - 17 ROOMS

734 Fairview Street • 1-888-948-1908 • 601-948-3429

Room Name	Dimensions	Sq. Ft.	Reception	Classroom	Conference	Banquet	Theatre
Library	—	450	—	—	15	—	—
Sun Room	—	285	—	—	6	6	20
Garden Room	—	3000	600	150	100	200	150
Carriage Room	—	750	—	30	50	50	50
Carriage House Suite	—	350	—	10	10	8	10
Drawing Room / Dining Room		525	—	—	—	6	—

OTHER HOTEL ACCOMMODATIONS WITH MEETING SPACE

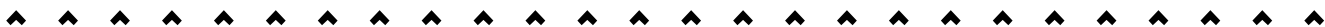

LA QUINTA INN NORTH - 144 ROOMS

616 Briarwood Drive • 1-800-531-5900 • 601-957-1741

Room Name	Dimensions	Sq. Ft.	Reception	Classroom	Conference	Banquet	Theatre
Board Room	—	—	—	10	—	—	—

OLD CAPITOL INN (BOUTIQUE HOTEL) - 24 SUITES

226 North State Street • 1-888-359-9001 • 601-359-9000

Room Name	Dimensions	Sq. Ft.	Reception	Classroom	Conference	Banquet	Theatre
Gala Ballroom	54' x 85'	4590	800	150	—	350	300
Gala Balcony	—	1340	—	—	—	—	—
Vieux Carre	24' x 47' plus 35' x 28'	2108	150	55+40	35+30	50+65	80+50
Camellia Room	24' x 47'	1128	80	55	30	65	80
Magnolia Room	35' x 28'	980	65	35	35	50	50
Azalea Boardroom	18' x 17'	306	—	15	10	—	20

STUDIO 6 - 120 SUITES







881 East River Place • 601-355-3599



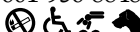
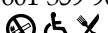

Room Name	Dimensions	Sq. Ft.	Reception	Classroom	Conference	Banquet	Theatre
Room 1	30' x 21'	651	25	25	15	25	25

ACCOMMODATIONS

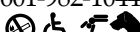

1. **America's Best Inn**
 2450 Highway 80 West
 601-353-0340
 38 Rooms • Exit 42B
2. **America's Best Value Inn**
 2655 I-55 South
 601-372-1006 • 1-800-800-8000
 75 Rooms • Exit 92A
3. **Baymont Inn**
 5709 I-55 North
 601-206-1616 • 1-800-424-6423
 121 Rooms
4. **Best Value Inn & Suites**
 5035 I-55 North
 601-982-1011
 120 Rooms
 Exit 100
5. **Best Western Executive Inn**
 725 Larson Street
 601-969-6555 • 1-800-WESTERN
 62 Rooms
6. **Best Western Jackson North**
 593 Beasley Road
 601-956-8686 • 1-800-528-1234
 60 Rooms
7. **Cabot Lodge Millsaps**
 2375 North State Street
 601-948-8650 • 1-800-874-4737
 205 Rooms
 Exit 98A
8. **Clarion Hotel,
 The Roberts Walthall**
 225 East Capitol Street
 601-948-6161 • 1-800-932-6161
 208 Rooms
 Exit 96A
9. **Coliseum Inn & Suites**
 614 Monroe Street
 601-352-8282
 51 Rooms • Exit 96B
10. **Comfort Inn Southwest**
 2800 Greenway Drive
 601-922-5600 • 1-800-228-5150
 76 Rooms • Exit 40A
11. **Courtyard by Marriott**
 6280 Ridgewood Court
 601-956-9991 • 1-800-321-2211
 117 Rooms • Exit 102B
12. **Days Inn-Coliseum**
 804 Larson Street
 601-352-7387 • 1-800-329-7466
 48 Rooms • Exit 96B
13. **Days Inn Southwest**
 2616 Highway 80 West
 601-969-5511 • 1-800-DAYS-INN
 50 Rooms • Exit 42B
14. **E.com Lodge**
 3880 I-55 South, Savannah Street
 601-373-1244
 80 Rooms • Exit 90A
15. **Extended Stay Deluxe**
 572 Beasley Road
 601-206-5757 • 1-800-257-3000
 94 Suites
16. **Extended Stay of America**
 5354 I-55 North
 601-956-4312 • 1-800-EXT-STAY
 108 Rooms • Exit 100
17. **Fairfield Inn by Marriott**
 5723 I-55 North
 601-957-8557 • 1-800-228-2800
 79 Rooms • Exit 102
18. **Fairview Inn (Bed & Breakfast)**
 734 Fairview Street
 601-948-3429 • 1-888-948-1908
 17 Rooms • Exit 98A
19. **Hampton Inn North**
 465 Briarwood Drive
 601-956-3611 • 1-800-HAMPTON
 119 Rooms • Exit 102
20. **Hampton Inn & Suites**
 320 Greymont Avenue
 601-352-1700 • 1-800-HAMPTON
 80 Rooms, 31 Suites
 Exit 96B
21. **Hill Top Inn**
 1065 S. Frontage Rd, I-20
 601-354-4455
 65 Rooms • Exit 44A
22. **Hilton Garden Inn Jackson/
 Downtown (formerly the
 Historic King Edward Hotel)**
 235 West Capital Street
 601-353-5464 • 1-800-HILTONS
 186 Rooms
 Exit 96A
23. **Hilton Jackson**
 1001 East County Line Road
 601-957-2800 • 1-888-263-0524
 273 Rooms
 Exit 103
24. **In-Town Suites**
 5731 I-55 North • 601-957-6833
 131 Rooms
25. **Inns of USA**
 4641 I-55 North
 601-981-3320
 65 Rooms • Exit 100
26. **Jackson Express**
 310 Greymont Avenue
 601-948-4466
 107 Rooms • Exit 96B
27. **Jackson Inn**
 5075 I-55 North
 601-366-9411 • 1-800-611-9151
 22 Rooms • Exit 102A
28. **Jackson Inn & Suites**
 5411 I-55 North
 601-899-9000 • 1-800-BEST-INN
 103 Rooms • Exit 100
29. **Jackson Marriott-Downtown**
 200 East Amite Street
 601-969-5100
 303 Rooms
 Exit 98B

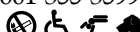
ACCOMMODATIONS (CONTINUED)

- 30. Jameson Inn**
 585 Beasley Road
 601-206-8923 • 1-800-526-3766
 67 Rooms
- 31. La Quinta Inn North**
 616 Briarwood Drive
 601-957-1741 • 1-800-531-5900
 144 Rooms • Exit 102A
- 32. Metro Inn**
 1520 Ellis Avenue
 601-355-7483 • 1-800-542-2923
 146 Rooms
 Exit 42B
- 33. Motel 6**
 6145 I-55 North
 601-956-8848 • 1-800-466-8356
 100 Rooms
 Exit 103
- 34. Old Capitol Inn
(Boutique Hotel)**
 226 North State Street
 601-359-9000 • 1-888-359-9001
 24 Rooms • Exit 96A
- 35. Parkside Inn**
 3720 I-55 North
 601-982-1122
 95 Rooms • Exit 98B
- 36. Poindexter Park Inn
(Bed & Breakfast)**
 803 Deer Park Street
 601-944-1392
 5 Rooms
- 37. Quality Inn**
 400 Greymont Avenue
 601-969-2230 • 1-800-300-8800
 135 Rooms
 Exit 96B
- 38. Red Roof Inn Fairgrounds**
 700 Larson Street • 601-969-5006
 1-800-THE-ROOF (1-800-843-7663)
 116 Rooms • Exit 96B
- 39. Regal Inn**
 1651 Terry Road • 601-355-0753
 110 Rooms • Exit 43B
- 40. Regency Hotel &
Convention Center**
 400 Greymont Avenue
 601-969-2141
 141 Rooms • Exit 96B

- 41. Regency Inn**
 1714 Highway 80 West
 601-354-4931
 70 Rooms • Exit 43B
- 42. Scottish Inn**
 2620 Highway 80 West
 601-354-3900
 52 Rooms • Exit 42B
- 43. Select 10 Motel North**
 4639 I-55 North
 601-982-1044 • 1-800-800-8000
 88 Rooms • Exit 100
- 44. Sleep Inn & Suites**
 209 South Gallatin Street
 60-896-0390
 68 Rooms • I-20 Exit 44A;
 I-55 Exit 96A
- 45. Studio 6**
 5925 I-55 North
 601-956-9988 • 1-800-557-3435
 70 Rooms • Exit 103
- 46. Studio 6**
 881 East River Place
 601-355-3599
 20 Rooms
 Exit 96C
- 47. Super 8**
 2355 Hwy 80 West
 601-948-0680 • 1-800-800-8000
 53 Rooms • Exit 42B
- 48. Super 8 North**
 6058 I-55 North
 601-956-9986 • 1-800-272-6233
 58 Rooms • Exit 102

Key to Hotel Amenities:

-  Non-smoking Rooms Available
-  Handicap Accessible Rooms
-  Restaurant
-  Lounge
-  Swimming Pool
-  Pet Friendly

NOTE: Hotel information was correct at publication date of October 2011..

RESTAURANTS WITH MEETING SPACE



HAL & MAL'S RESTAURANT

200 South Commerce Street
601-948-0888

Location: Exit Pearl Street from Interstate 55, one block south off North State Street between the Old Capitol and Tombigbee Street.
Capacity: Meeting 350—Meal 250
Features: Restaurant, lounge, patio

OFF-SITE MEETING FACILITIES

MISSISSIPPI FAIRGROUNDS COMPLEX

1207 Mississippi Street

601-961-4000

FAX 601-354-6545

Location: Near downtown Jackson at High and Pearl Streets.

This complex is composed of the Mississippi Coliseum, the Mississippi Trade Mart, two Agricultural and Industry Buildings, and Equine Center.

AGRICULTURE AND INDUSTRY BUILDINGS LIVESTOCK FACILITIES EQUINE CENTER

Location: In the Fairgrounds Complex.

This multi-purpose facility is ideally suited for large events, exhibitions and industry trade shows.

Features: Each building 96' x 180' (17,280 square feet)

Exhibits: 256-10' x 10' booths, 320-8' x 10' booths

Electricity: 110/220V single phase

Ample parking.

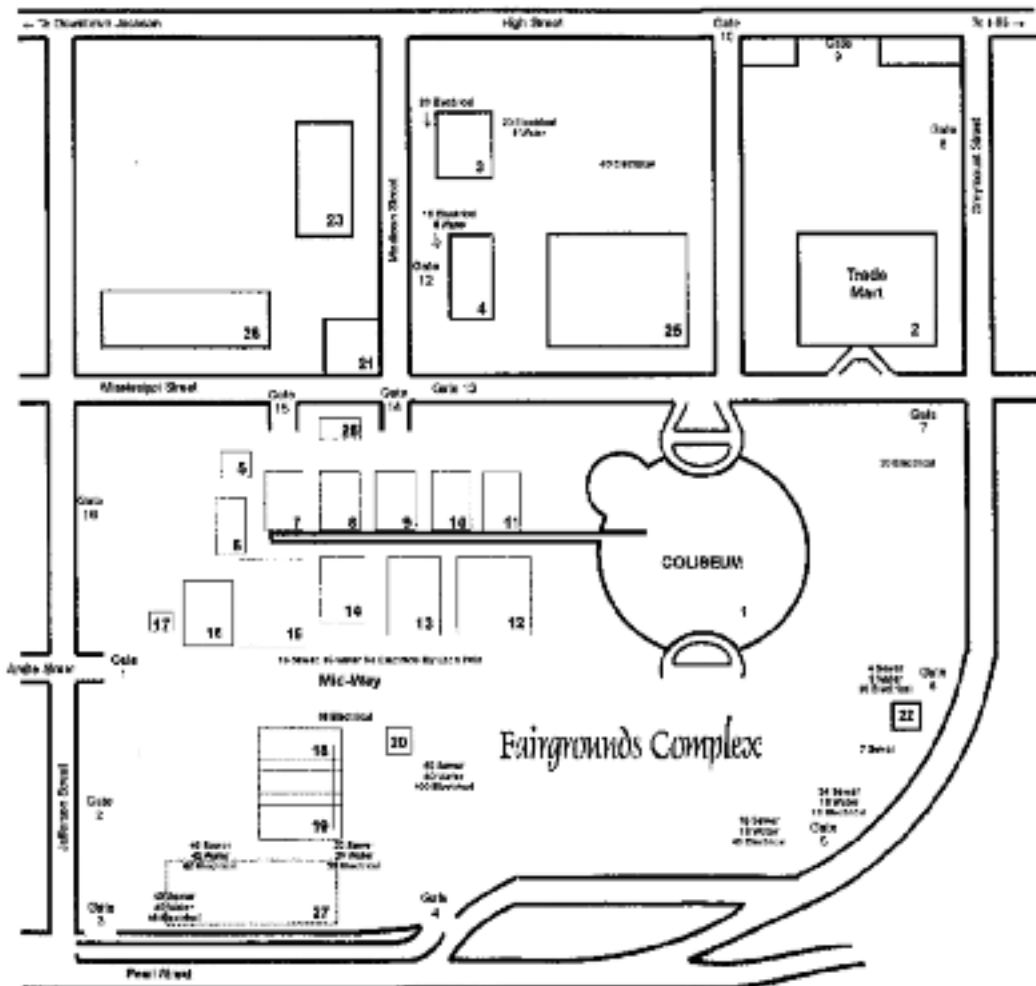

- | | | |
|------------------------|--|--------------------------------------|
| 1. Coliseum | 10. Horse Barn | 19. Industrial Building |
| 2. Trademart | 11. Corral (Multi-Use) | 20. Comfort Station |
| 3. Multi-Purpose | 12. Livestock Barn | 21. Mississippi Street Armory |
| 4. Horse Barn | 13. Livestock Barn | 22. Midway Comfort Station |
| 5. Hay Barn | 14. Judging Arena | 23. Horse Barn (Steel Building) |
| 6. Children's Barnyard | 15. Livestock Barn (Dairy) | 24. Expo Center |
| 7. Hog Barn | 16. Livestock Barn (Milk Parlor and Dairy) | 25. Maintenance & Grounds Department |
| 8. Sheep Barn | 17. Cane Mill | 26. Campground |
| 9. Horse Barn | 18. Agriculture Building | 27. Propane Tank |

OFF-SITE MEETING FACILITIES

THE MISSISSIPPI COLISEUM

1207 Mississippi Street

601-961-4000

FAX 601-354-6545

Features: 6,500 permanent seating, 2,650 temporary
 Arena Floor: 25,449 square feet • Stage: 60' X 40' (portable)
 Exhibits: 130-8' X 10' booths • Arena height: 70'
 Complete sound and lighting facilities.
 Backstage facilities: four group and eight individual dressing rooms.
 Loading dock with ground level 14' door opening.
 Ample parking.

This modern facility is strategically located and readily accessible from all major thoroughfares. It is ideally suited for any convention or public show.

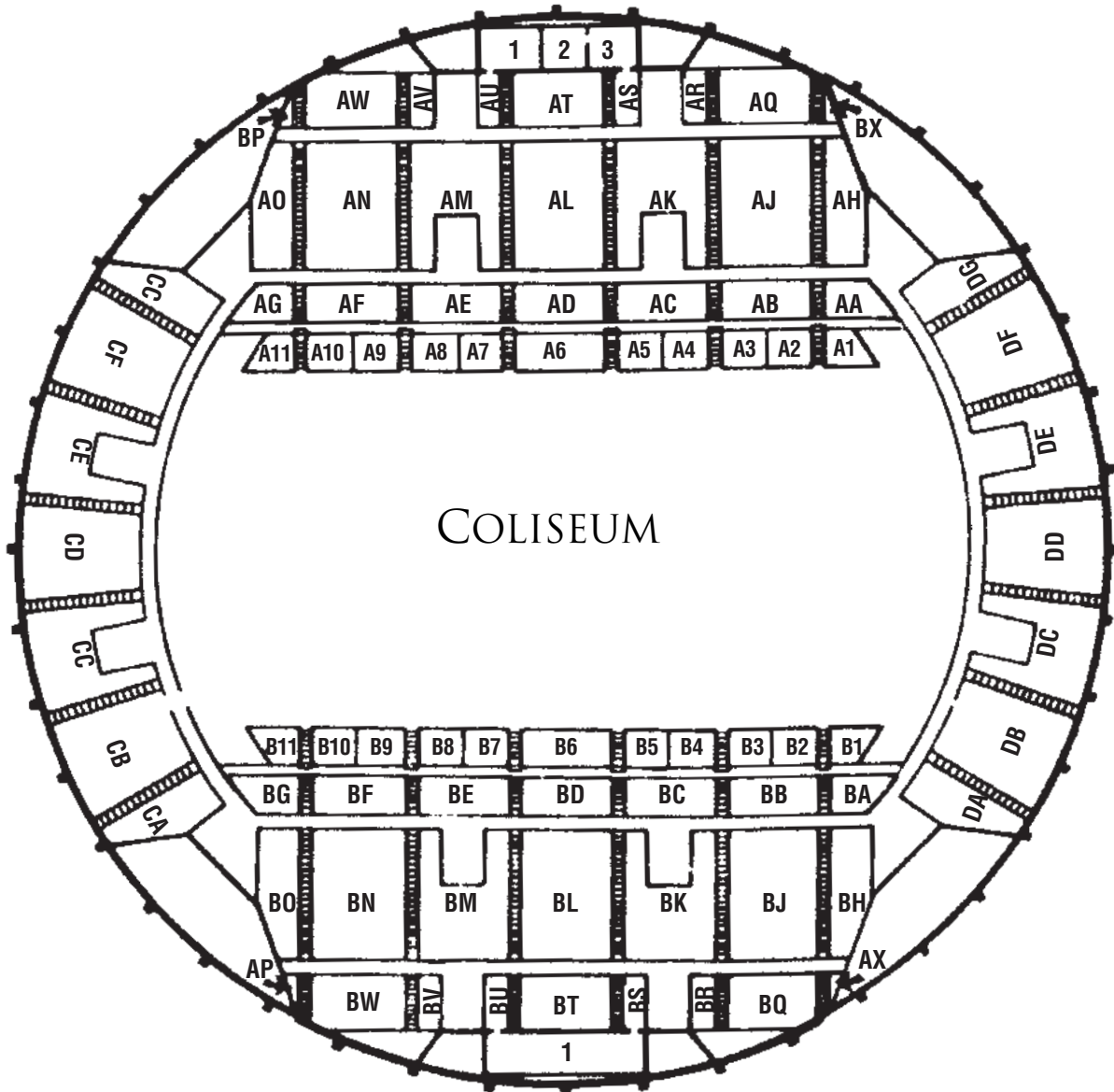

OFF-SITE MEETING FACILITIES

THE MISSISSIPPI TRADE MART

1207 Mississippi Street

601-961-4000

FAX 601-354-6545

The Trade Mart was designed for maximum flexibility with 67,140 square feet of space. This multi-purpose facility can be utilized in a variety of ways serving as a large exhibit hall for trade and public shows, banquets, conventions, and special events.

Versatile, the West Bay features 23,940 square feet, and the main convention hall has 43,200 square feet which can be divided into two separate meeting halls. Each of these areas features its own sound and lighting equipment with portable stage to handle medium-size events. For smaller groups, there are three meeting rooms ideal for sales meetings, seminars, or discussion groups.

The Trade Mart is readily adaptable to meet the specific needs of any event.

- 66,600 square feet total column-free exhibit space.
- West Bay: 180' x 133' exhibit area. 23,940 square feet.
- Exhibits: 125 (18' x 10') booths
- Maximum capacity: 1,500
- Middle and East Bay: 180' x 240' exhibit area. 43,200 square feet
- Exhibits: 250 (8' x 10') booths
- Maximum capacity: 2,880
- This area can be divided by a soundproof partition forming two 180' x 120' self-contained exhibit areas.
- Ceiling height: 25'
- Color corrected lighting
- Separate 35' x 80' meeting room; easily divided into three 26' x 35' rooms each seating 125 persons
- 110' covered loading dock
- One 20' x 20' drive-in overhead door
- Three 14' x 12' drive-in loading doors
- Electrically 110/208 volts, single-and three-phase (utilities are located at 30' intervals in floor boxes)
- Water and floor drains available
- Fully heated and air conditioned
- Office for service contractor
- Unlimited floor strength
- Convenient gas lines
- Ample parking

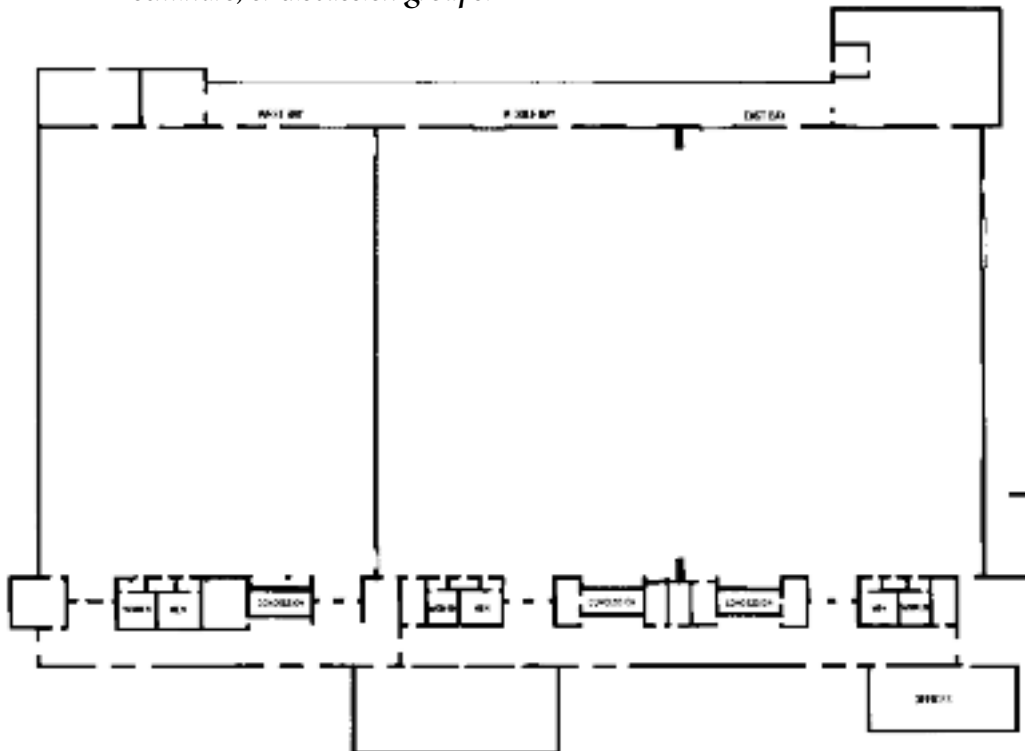

OFF-SITE MEETING FACILITIES

RUSSELL C. DAVIS PLANETARIUM

201 East Pascagoula Street
601-960-1550

Location: Exit Pearl Street off Interstate 55.
Largest Room Capacity: Meeting 200, stage available.
Handicap accessible

EXHIBITION AREA

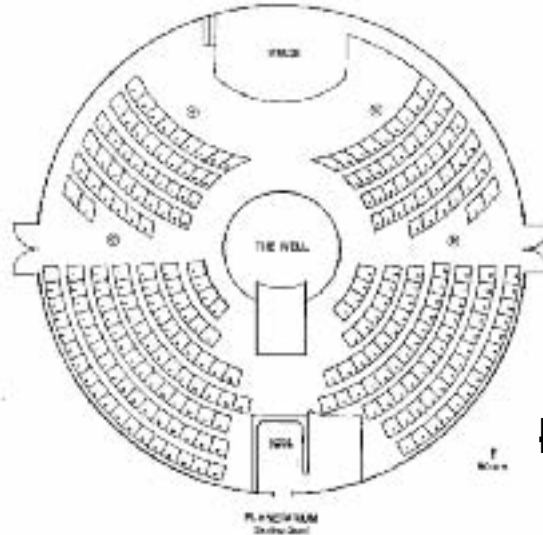

EXHIBITION AREA

THALIA MARA HALL

225 East Pascagoula Street
601-960-1537

Location: Exit Pearl Street from Interstate 55, take left on Lamar Street, take right on Pascagoula, next door to Mississippi Museum of Art.

Features:

- Seating capacity 2,500 • 60' wide proscenium
- Acoustical shell • Dressing rooms with showers
- Adjacent meeting or reception room

Handicap accessible

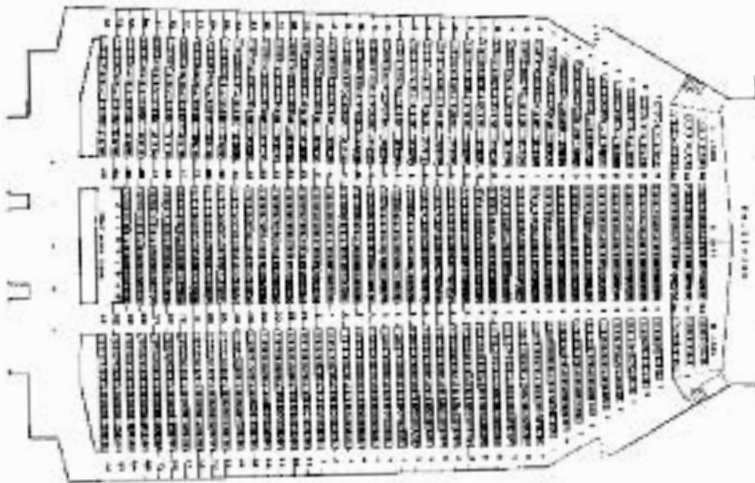

MAIN FLOOR STAGE

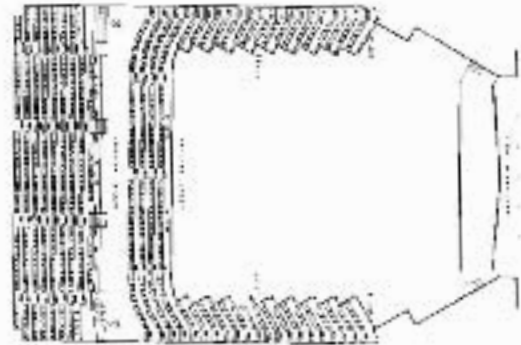

BALCONY & LOGE SEATS

OFF-SITE MEETING FACILITIES

CAPITOL CLUB

125 South Congress
601-969-7101

Name of Room	Capacity – Luncheon
Governor’s Room	18
Card Room	6
Tinsley Room*	60
Smackover Room*	30
Discovery Room*	40
Grill*	44
*Can be combined as “South End”	200 seated, 275 reception
Main Dining Room	115 seated, 150 reception

DULING HALL

622 Duling Avenue
601-362-8440
www.dulinghall.com

Location: Fondren District in Downtown Jackson.
Features: Air conditioning/heating, stage with sound, lighting, and AV equipment, kitchen, full-service bar, and bathrooms.

For weddings, receptions, meetings, private parties, lunches, presentations, and more, historic Duling Hall in the Fondren neighborhood offers a perfect venue. The space, a total of 5,000 square feet, includes an 800-square-foot stage with sound, lights, and AV equipment, a fully equipped kitchen, and full-service bar. The hall will seat 300 around tables (restaurant-style), and more auditorium-style. Two spacious outdoor patios flank the facility.

FONDREN HALL

4436 North State Street
601-500-8000
www.fondrenhall.com

This 7,000-foot flexible banquet hall may be divided into two rooms. The large hall seats 420 banquet-style.

JACKSON ZOOLOGICAL PARK

2918 West Capitol Street
601-352-25800

Name of Room	Capacity	Banquet	Classroom	Reception
The Community Center	75	—	75	50
The African Boardwalk	—	—	—	—
The Gertrude C Ford Education Center				
Small Classroom/Lecture	45	—	45	—
Large Classroom	75	—	75	—
Display Hall (with porch)	—	—	—	—
Mississippi Backyard Creatures Building	—	—	—	75
Mississippi Water Building	150	48	—	150
Bear Viewing Area	25	—	—	25
Ramada Pavilion	50	30	—	50
Entire Zoo	2,500	—	—	—

OFF-SITE MEETING FACILITIES

MISSISSIPPI AGRICULTURE & FORESTRY MUSEUM/ NATIONAL AGRICULTURAL AVIATION MUSEUM

1150 Lakeland Drive

601-713-3365 • 1-800-844-8687

Location: Exit Lakeland Drive off I-55, turn left 1/2 block.

Features: Air conditioning/heating, tables and chairs, stage and PA system, kitchen and bathrooms.

Name of Room	Capacity	Banquet	Classroom	Theatre	Reception	Sq. Ft.
Ethnic Heritage Center	400	225	100	300	400	3764
Forestry Auditorium	600	400	200	550	600	4435
Sparkman Auditorium	600	400	225	550	600	5035
Heritage Auditorium	145	—	—	145	—	1800
Masonic Lodge	75	65	25	75	75	850
Pavilion (outdoor)	200	100	—	—	100	2800
Church	100	—	—	100	—	1000

MISSISSIPPI CHILDREN'S MUSEUM

2145 Highland Drive

601-709-8972

www.mississippichildrensmuseum.com/visit/facility-rental/

Location: Exit Lakeland Drive off I-55, turn right onto Highland Drive.

The Mississippi Children's Museum features colorful design and creative inspiration for all types of audiences and events. Contact Cynthia Till at 601-709-8972 or email cynthia@mcm.ms for details on the following spaces:

- Full Museum (39,828 square feet): Gain access to all the fun, fabulous, and interactive exhibit galleries for your event.
- Classroom Space (515 square feet): Great for smaller groups, continuing education classes, small conferences, and more.
- Traveling Exhibit Space (2,350 square feet): Perfect for larger conferences, luncheons, award ceremonies, etc.
- MCM Education Center (1,600 square feet): Enjoy the private, indoor and outdoor clubhouse facility, newly updated and renovated.

MISSISSIPPI MUSEUM OF ART

380 South Lamar Street

601-960-1515

Location: Mississippi Arts District in Downtown Jackson.

Name of Room	Capacity	Banquet	Classroom	Reception
Trustmark Grand Hall, Lobby and Grand Patio	600	150	200	600
Yates Community Room	80	55	80	80

MISSISSIPPI SPORTS HALL OF FAME & MUSEUM

P.O. Box 16021

601-982-8264 • 1-800-280-FAME

Location: Exit Lakeland Drive off I-55, turn left 1/2 block, outside Agriculture & Forestry Museum.

Features: Advanced audio/visual equipment, laptop presentation capability and fully equipped kitchen.

Capacity	Banquet	Classroom	Theatre	Sq. Ft.
200	150	180	200	2200

OFF-SITE MEETING FACILITIES

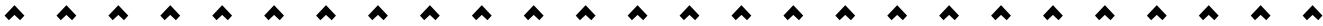

OLD CAPITOL MUSEUM

100 South State Street

601-576-6902

Location: Downtown, East end of Capitol Street at State Street

Name of Room	Capacity	Detail
Chancery Court	125	Reception Only
House of Representatives	200-256	Main Floor & Balcony
William Nichols Room	40+	Theater or Classroom

SMITH ROBERTSON MUSEUM & CULTURAL CENTER

528 Bloom Street

601-960-1457

Location: Historic Farish Street District in Downtown Jackson

Name of Room	Capacity	Theatre	Reception
Auditorium	120	120	—
Atrium Area	200	60	200

THE ALAMO THEATER

333 North Farish Street

601-352-3365

Location: Historic Farish Street District in Downtown Jackson.

Theatre

524

THE SOUTH

627 East Silas Brown

601-966-4518

Location: Downtown, south end of State Street between State and Jefferson Streets.

The South is one of Jackson's most unique event venues, offering rustic charm with a modern twist. With 19,000 square feet, there's plenty of room for parties, receptions, and more in this flexible space.

UNION STATION

300 West Capitol Street

601-960-1815

Location: Downtown, West Capitol and Court Street.

The beautifully restored, historic Union Station, now a multi-modal transportation center for Jackson, offers a 5,000-square-foot ballroom that seats 300 banquet-style and a smaller room that seats 50-75 theater-style.

SPORTS FACILITIES

MISSISSIPPI VETERANS MEMORIAL STADIUM

2531 North State Street

601-354-6021

Located at North State Street and Woodrow Wilson Boulevard, this state-owned facility is centrally located with excellent access to major highways and four-lane traffic arteries. Expanded in 1979, Memorial Stadium now seats 60,492 including 219 elevated wheelchair spaces. The facilities' horse-shoe configuration is ideally suited for concerts, and other performance events. Luther Van Dross and *NSYNC performed to maximum capacity crowds. The natural Bermuda grass playing surface has been called the best playing surface in college football.

Features:

- Excellent support facilities
- Field lighting for TV
- On-site parking for over 4,000 cars (another 4,000 within 2 blocks)
- Excellent flow of traffic in and out
- Roomy air-conditioned team dressing rooms
- Much-copied PA sound system
- 3-story Press Box with its own inside PA and elevator
- 400 car reserved parking lot

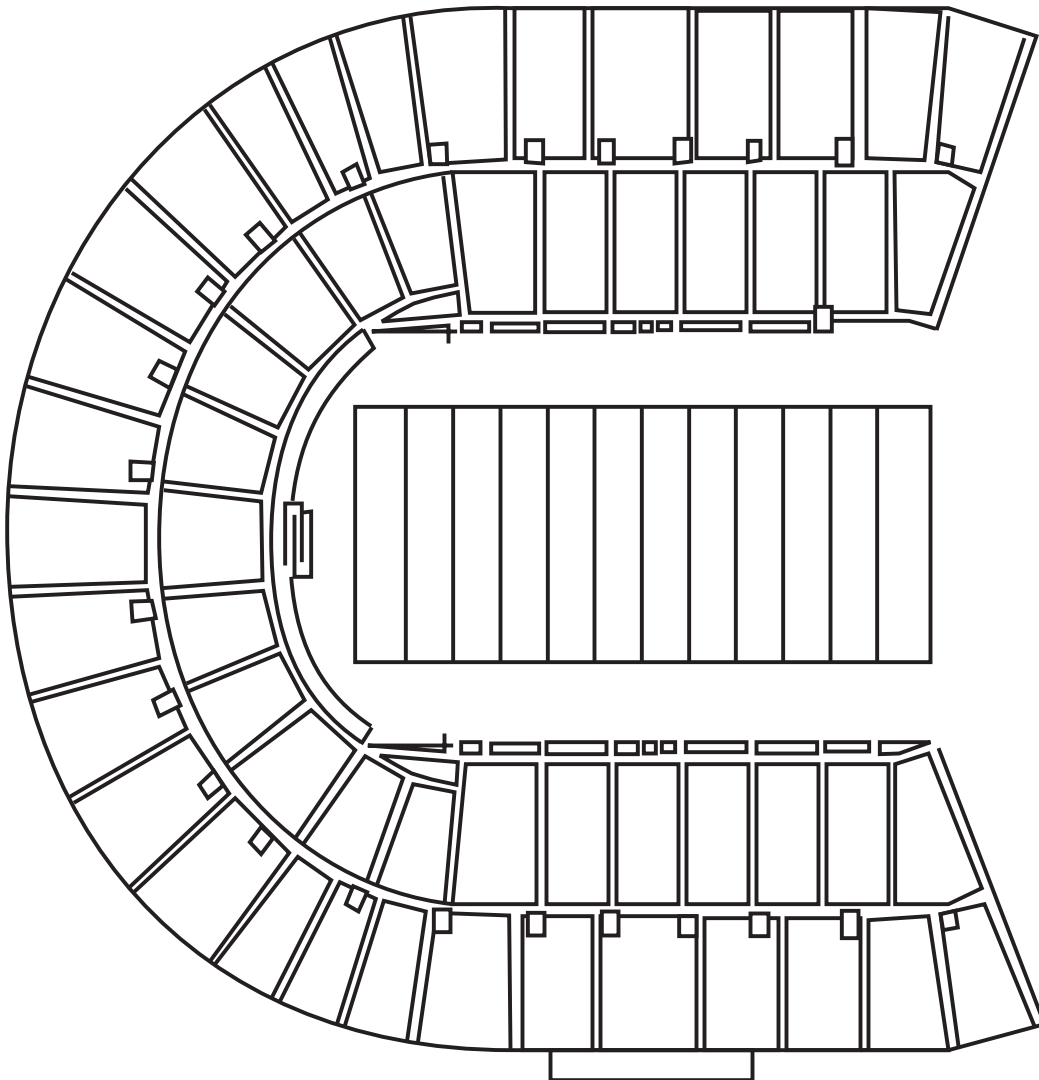

SPORTS FACILITIES

SMITH-WILLS STADIUM

1200 Lakeland Drive

601-362-2294

This 5,200 seat facility is multi-use for baseball and other events such as outdoor concerts. Call to request schedules and ticket information.

Features:

- Lights • Scoreboard • Sprint Turf
- Concession stand • Dressing rooms/showers
- Restrooms • Parking on-site

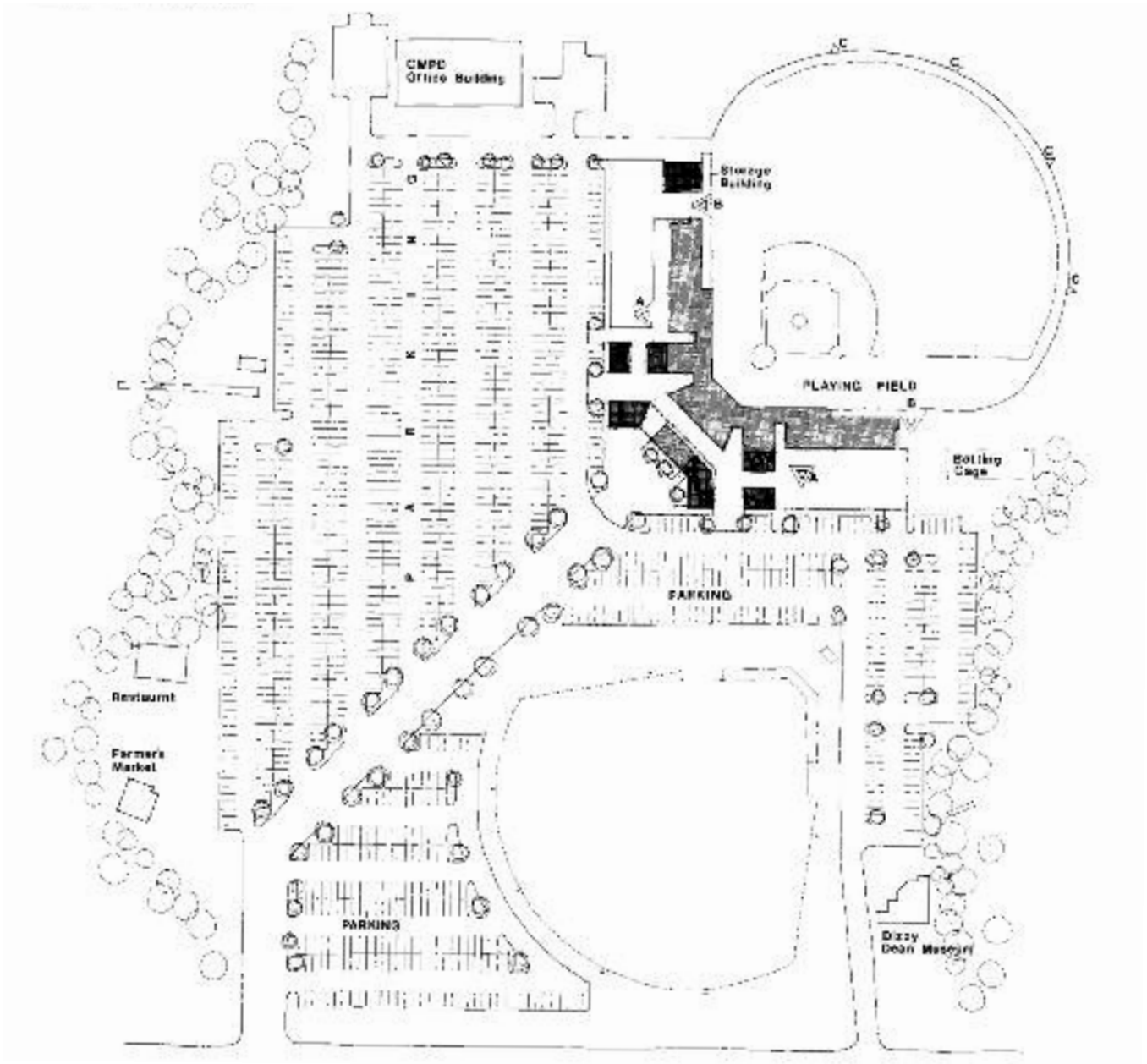

AREA SPORTS FACILITIES

SOCCER

- **Battlefield Park**
953 Porter Street
601-960-0716

One (1) soccer field.
 - **Buddy Butts Park**
7 North McRaven Road
601-960-0471

Eleven (11) soccer fields, four (4) lighted fields for U6 through U19, restrooms, picnic areas, and concessions.
 - **Callaway Soccer Fields**
601 Beasley Road
601-987-3535

Two (2) champion size soccer fields.
 - **H.T. Newell Field**
Riverside Drive
601-968-5956

Home to Belhaven University Soccer; seats 7,500.
 - **Jackson Futbol Club**
Westbrook Road
601-956-6184

Eleven (11) soccer fields, two (2) lighted fields with irrigated bermuda turf for U6 through U19, restrooms, and concessions.
 - **JSU Soccer Complex**
Jackson State University
601-979-7821
 - **Harper Davis Field**
Millsaps College
601-974-1000
-

BASEBALL/SOFTBALL FACILITIES

- **Grove Park**
4126 Parkway Avenue
601-960-0643

Four (4) lighted fields, swimming pool, basketball, tennis, 9-hole golf course, concessions, and restrooms.
 - **JSU Baseball Stadium**
1400 J.R. Lynch Street
601-979-7821

Measures 365 down the lines, 325 to the power alleys, and 400 to center field with seating for 800.
 - **JSU Softball Stadium**
1400 J.R. Lynch Street
601-979-7821

Seats 200.
 - **Lakeland Park**
1200 Lakeland Drive
601-960-0716

Nine (9) lighted fields for T-ball to Pony League with seating, restrooms, and concessions.
 - **Legion Complex**
4500 South Drive
601-960-0629

Six (6) lighted softball fields and two (2) lighted baseball fields with seating, swimming pool, and restrooms.
 - **Leavell Woods Park**
351 Dona Drive
601-960-0716

Four (4) lighted fields for T-ball to high school, concessions, and restrooms.
 - **Millsaps College Twenty Field**
1701 North State Street
601-974-1188

Features natural grass and seats up to 500.
 - **Millsaps Softball Complex**
1701 North State Street
601-974-1188

Features natural grass and seats up to 200.
 - **Smith-Wills Stadium**
1200 Lakeland Drive
601-981-1414

See Multi-Purpose Sports Facilities.
- Three Fields or Less:**
- **Battlefield Park**
953 Porter Street
601-960-0716

Two (2) baseball fields.
 - **Sykes Park**
520 Sykes Road
601-960-0716

Three (3) softball fields.

PUBLIC GOLF

- **Buddy Butts Park Tee-Time Golf Range**
7 North McRaven Road
601-923-3360
 - **Grove Park**
1800 Walter Dutch Drive
601-960-2074
9-hole golf course, baseball fields, clubhouse, tennis courts, swimming pool, playground, and restrooms.
 - **LeFleur's Bluff State Park**
2140 Riverside Drive
601-362-5485
9-hole golf course, open year round.
 - **Sunny Guy Municipal Park**
3200 Woodrow Wilson
601-960-1905
18 holes with pro shops, open seven days a week, year round.
-

BASKETBALL

- **Belhaven University**
Heidelberg Gymnasium
1500 Peachtree Street
601-968-5956
Regulation hardcourt surface, seating for 500, concessions, dressing rooms, and restrooms.
 - **George Kurts Gymnasium**
125 Gymnasium Lane
601-960-1883
94' x 50' synthetic rubber/vinyl surface, air conditioned, seating for 300, dressing rooms, and restrooms.
 - **Millsaps College**
Harper Dansfield Gymnasium
1701 North State Street
601-974-1188
 - **Champion Gymnasium**
1355 Hattiesburg Street
601-960-1422
84' x 50' synthetic surface, air conditioned, seating for 120, concessions, dressing rooms, and restrooms.
 - **Jackson State University**
Lee E. Williams Gymnasium
1400 J.R. Lynch Street
601-979-7821
Seats up to 8,000, locker rooms, weight room, sauna, and training rooms.
 - **Mississippi Basketball Athletics Complex**
2240 Westbrook Road
601-957-7373
51,000 square feet, seating for 3,300. Five (5) college regulation courts.
 - **Walter Payton Center**
1400 J.R. Lynch Street
601-979-7821
100,000-square-foot facility with three (3) hard courts.
-

TRACK AND FIELD

- **JSU Mark Epps Track & Field Facility**
1400 J.R. Lynch Street
601-979-7821
Renovated in 2004. Hosts JSU men's and women's track and field.
 - **Millsaps College**
1701 North State Street
601-974-1188
-

FRISBEE GOLF

- **LeFleur's Bluff State Park**
2140 Riverside Drive
601-362-3885
18-hole course.

TENNIS FACILITIES

- **Belhaven University Tennis Complex**
1500 Peachtree
601-968-5956

5 lighted courts.
 - **Dorothy Vest Tennis Center**
953 Porter Street
601-960-1388

This facility offers six (6) clay courts, six (6) lighted hard courts, one (1) non-lighted court, a pro shop, concessions, and restrooms.
 - **JSU Tennis Facility**
1400 J.R. Lynch Street
601-979-7821

Features 12 lighted courts with scoreboards and stadium seating for 100.
 - **Medgar Evers Community Center**
3159 Edwards Avenue
601-960-1741

84' x 50' multi-purpose surface, seating for 150.
 - **Millsaps College**
1701 North State Street
601-974-1188

Four (4) lighted courts.
 - **Parham Bridges Tennis Center**
5055 Old Canton Road
601-956-1105

Selected as one of the top 50 Municipal Tennis Centers in America. 15 lighted plexipare courts, pro shop, and multi-use clubhouse. Includes one-mile walking trail.
 - **River Hills Club**
3600 Ridgewood Road
601-987-4450

River Hills Club has 21 tennis courts and offers 3 different court surfaces. State-of-the-art underground watered hydro-courts, 8 hard courts, and 4 indoor courts. All of our outdoor courts are lit and there are no fees for members using the outdoor courts.
 - **Sykes Park**
520 Sykes Road
601-368-7407
 - **Tennis Center South**
1517 McDowell Road
601-960-1712

Offers 14 lighted, hard-surface courts, including 200-seat stadium court, clubhouse, pro shop, restroom, lockers.
 - **Westside Community Center**
1450 Wiggins Road
601-960-1650

75' x 42' hardwood surface, seating for 225, dressing rooms, and air conditioning.
-

FOOTBALL

- **Harper Davis Field**
Millsaps College
1701 North State Street
601-974-1000

Field features artificial turf and seating for 3,000.
- **H.T. Newell Field**
900 Riverside Drive
601-968-5956

Home to Belhaven Football with seating for 7,500.
- **Veterans Memorial Stadium**
2531 North State Street
601-354-6021

Expanded in 1970, Veterans Memorial Stadium now holds 60,492. The facility's horseshow configuration is ideal for concerts and other performance events.

MULTI-PURPOSE SPORTS FACILITIES

- **Jackson Convention Complex**

*105 East Pascagoula Street
601-960-2321*

The sparkling new Jackson Convention Complex offers over 330,000 sq. ft. of meeting space with an 85,000-sq.-ft. exhibit hall used to host concerts, tradeshow, and a wide variety of sporting events.

- **Kirk Fordice Equine Center**

*451 Monroe Street, Mississippi Fairgrounds Expo Center
601-961-4000*

One of the South's most modern livestock facilities. This building is used every week for cattle shows, horse shows, markets of all types. Dirt floor arena 260' x 120' with 2,500 chair back seats, concessions, sound system, and scoreboard.

- **Mississippi Coliseum**

*1207 Mississippi Street
601-961-4000*

This modern facility is an all-season area with large capacity seating including 6,500 permanent seating and 2,650 temporary seating. Arena floor: 25,449 sq. ft. Arena height: 70'. Spacious stage complete with sound and lighting facilities available.

- **Mississippi Trade Mart Center**

*175 East Capitol Street
601-961-4000*

This multi-purpose facility can be utilized in a variety of ways—serving as a large exhibit hall for trade and public shows to banquets, conventions, and special events. 66,600 sq. ft. of column-free exhibit space.

- **Mississippi Veterans Memorial Stadium**

*2531 North State Street
601-354-6021*

Expanded in 1970, Veterans Memorial Stadium now holds 60,492. The facility's horseshoe configuration is ideal for concerts and other performance events.

- **Smith-Wills Stadium**

*1200 Lakeland Drive
601-981-1414*

Once a major league stadium, this 5,200-seat multi-use facility now hosts baseball, football, and other outdoor sporting events.

- **T.B. Ellis Physical Education Center**

*1400 J.R. Lynch Street
601-979-7821*

Multi-purpose facility located at Jackson State University. Olympic-style pool, two (2) basketball courts, and floor space for indoor tennis, table tennis, badminton, and volleyball.

- **Walter Payton Health and Wellness Center**

*1400 J.R. Lynch Street
601-979-7821*

100,000-square-foot facility that houses a strength and aerobic center, three (3) basketball courts, three (3) racquetball courts, squash court, and spacious locker rooms for men and women.

RECREATION & SHOPPING

RECREATION

Bowling

Cotton Bowl
3003 Lynch Street • 601-354-5738

Paradise Lanes
820 Cooper Rd. • 372-7700

LeFleur's Bluff State Park
2140 Riverside Drive • 601-362-3885

The only state park located within the city limits. Beautiful grounds and peaceful scenery features clubhouse, swimming pool, picnic areas, tennis, boating, fishing and camping, a nature trail, and a 9-hole golf course. 30 RV camp pads, bathhouse and sanitation dump station.

Mississippi Veterans Memorial Stadium
2531 North State Street • 601-354-6021

Located at N. State Street and Woodrow Wilson Blvd., this state-owned facility's central location easily accesses major highways and four-lane traffic arteries. Expanded in 1979, it seats 60,492, including 219 elevated wheel chair spaces. The facility's horse-shoe configuration is ideally suited for concerts and performance events. The natural Bermuda grass playing surface has been called the best playing surface in college football.

Mississippi Coliseum & Fairgrounds
1207 Mississippi Street • 601-961-4000

The Coliseum and Fairgrounds host a variety of entertainment for Mississippi. The fairgrounds, the oldest in the Southeast, provide the site for the Mississippi State Fair in October, the Dixie National Rodeo and Livestock Show in February (the largest east of the Mississippi River) a variety of Cutting Horse Shows, and big name entertainers in concert throughout the year. Call for current schedules and ticket information.

Smith-Wills Stadium
1200 Lakeland Drive • 601-362-2294

This 5,200 seat facility is multi-use for baseball and other events such as outdoor concerts. Call for current schedules and ticket information.

WALKING & EXERCISE TRAILS

Grove Park1/2 mile
Hico Park1/2 mile
Leavell Woods Park3/4 mile
Manhattan Park3/4 mile
Natural Science Museum6 1/2 mile
Parham Bridges Park1 mile
Sheppard Brothers Park1/2 mile
Westside Park1/2 mile
Willie Henry Park1/4 mile

PUBLIC GOLF COURSES

Grove Park Course
1800 Walter Dutch Welch Dr.
601-960-2074
9 holes; par 36.

LeFleur's Bluff Golf Course
1205 Lakeland Dr. • 601-362-5485
www.mdwfp.com/LeFleursBluff.asp
9 holes; par 35.

Live Oaks Golf Club
11200 Highway 49 • 601-982-1231
18 holes; par 72

Patrick Farms Golf Club
300 Club House Dr. • 601-664-0304
18 holes; par 72.

Sonny Guy Municipal Course
3200 Woodrow Wilson Dr. • 601-960-1905
18 holes; par 72.

HUNTING & FISHING

MS Department of Wildlife Fisheries & Parks
1505 Eastover Dr. • 601-432-2400
<http://home.mdwfp.com>

CAMPGROUNDS & RV PARKS

LeFleur's Bluff State Park
2140 Riverside Drive • 601-362-3885

Features: clubhouse, picnic areas, tennis, boating and fishing, 9-hole golf course, nature trail, 30 RV camp pads, bathhouse and sanitation dump station.

Swinging Bridge RV Park
5750 I-55 South
601-502-1101

Timberlake Campground
143 Timberlake Drive
Exit 98B Lakeland Drive, 5.8 miles, then turn left on Old Fannin Rd., 3.7 miles on left past McDonald's • 601-992-9100

Features: full hook-ups, showers, swimming pool, tennis court, shaded and waterfront lots.

ARCHERY RANGES

Bill's Archery Shops
810 Clearmont Drive, Pearl • 601-939-4380

RIFLE & PISTOL RANGES

Magnolia Rifle & Pistol Club
2042 Meadowbrook Road • 601-362-7771

HEALTH CLUBS

Baptist Healthplex
717 Manship Street • 601-968-1766

The Courthouse
46 Northtown Drive • 601-956-9729

The Courthouse
100 East Capitol Street • 601-948-8688

The Courthouse
2625 Courthouse Circle • 601-932-4800

Fitness Lady
I-55 North
601-957-0045

Quest Fitness
1693 Beasley Drive • 601-982-7360

YMCA
I-55 Branch
840 East River Place
601-948-3090

RECREATION & SHOPPING

SHOPPING CENTERS & MALLS

Ag Museum: General Store
Lakeland at I-55 North (Exit East)
601-713-3365

Banner Hall
I-55 North Frontage West
601-366-7619

Canton Mart Square
Canton Mart at Old Canton Rd.
601-942-5147

Fondren District
North State Street
601-981-9606

Greater Belhaven Market
(Saturdays through Dec. 28)
Mississippi Farmer's Market
High Street at Jefferson Street
601-359-1159

Highland Village
I-55 North Frontage East
and Northside Drive
601-982-5861

Jackson Zoological Park: Gift Shop
2918 West Capitol Street
601-352-2581

Maywood Mart
Northside Drive at I-55 North
601-713-1421

Metrocenter Mall
Highway 80 at I-20 & I-220
601-354-7800

Mississippi Farmer's Market
I-55 at High Street
Mississippi Fairgrounds
601-354-6573

Mississippi Museum of Art:
The Museum Store
Pascagoula Street at Lamar Street
601-960-1515

Mississippi Museum of Natural
Science: Dragonfly Shoppe
2148 Riverside Drive
601-354-7303

Old Capitol Gift Shop
William F. Winter Archives Bldg.
200 North Street
601-576-6920

Old Farmers Market
North West St. at Woodrow Wilson

Pear Orchard Village
County Line Road at
Pear Orchard Road
601-977-9258

Regions Plaza
Capitol St. at North West St.
601-949-7711

Smith Robertson Museum:
Gift Shop
328 Bloom Street
601-960-1457

Westland Plaza
Ellis Avenue at Robinson Road

Woodland Hills Shopping Center
Duling Avenue at Old Canton Road
601-981-6020

ANTIQUES

Annelle Primos & Associates
Highland Village, Suite 126 • 601-362-6154

Antique Market
3009 North State • 601-982-5456

Batte Furniture & Interiors
1010 East Northside Drive • 601-366-0335

High Street Antique Mall
806 Larson Street • 601-354-5222

Interior Spaces
5060 I-55 North • 601-956-4199

Interiors Market
659 Duling Avenue • 601-981-6020

Jim Westerfield Antiques & Interiors
4429 Old Canton Road • 601-362-7508

Oriental Shoppe
Highland Village, Suite 156 • 601-362-4646

Reaves' Oriental Rugs
420 Meadowbrook Road • 601-362-7707

St. Martin's Gallery
2817 Old Canton Road • 601-362-1977

Ye Olde Lamp Shoppe
4505 I-55 North Frontage Road
601-362-9311

ARTISTS' STUDIOS & ART GALLERIES

Brown's Fine Art & Framing
630 Fondren Place
601-982-4844

Fischer Galleries
3100 North State Street, Suite 103
601-366-8833

Fondren Art Gallery
601 Duling Avenue
601-981-9222

Fondren Corner Gallery
State Street at Duling Avenue
601-856-7546

Gaddis Group Studio
2906 North State Street, Suite 206
601-366-9522

Glass House
2906 North State Street, Suite B-7
601-212-6635

Jackson Municipal Art Gallery
839 North State Street • 601-960-1582

The Gallery building, originally built in the late 1860s as a stately private home, stands today as one of the oldest surviving historic structures in Jackson. As the Municipal Art Gallery, it has become a cultural focal point for hundreds of local artists. On the first Sunday of every month, the Gallery hosts an Open House and presents a new art exhibition. Come by for a closer look at history in all its vibrant colors.

- Tour Time: 30 minutes-1 hour
- Hours: Tuesday-Saturday 9 a.m.-5 p.m., Sunday 2-5 p.m.
- Admission: Free

Special Services:

- Handicap accessible
- Motorcoach parking

Just Joy Art
622 Duling Avenue
601-368-9568

Light and Glass Studio
523 South Commerce Street
601-942-7285

Mississippi Crafts Center
Fondren Corner Gallery
State Street at Dull
601-981-4426

Nunnery's Art Gallery
426 Meadowbrook Road
601-981-4426

One Blu Wall Gallery
2906 North State Street
601-713-1244

Pearl River Glass Studio
142 Millsaps Avenue • 601-353-2497
Stained glass artist, Andy Young

Richard McKey's Studio
3242 North State Street
601-573-1060

Southern Breeze Gallery
4500 I-55 North, Suite 160
Highland Village
601-982-4222

The Cedars
4145 Old Canton Road
601-366-5552

The Knit Studio
1481 Canton Mart Road
601-991-3092
www.theknitstudio.com

Twenty Nine 06 Studios
2906 North State Street, Suite 106
601-366-8010

Wolfe Studio & Gallery
4308 Old Canton Road • 601-366-1844

In the forest in the midst of Jackson, Karl and Mildred Wolfe created in a variety of forms an art reflective of their lives and environment enhancing creations that now grace many collections, private and public in Mississippi and far beyond. The Gallery is open by appointment only except during the Christmas Season. Original Artwork, Limited Edition prints, custom framing, hand-crafted furniture, and hand-carved mirrors.

NATIVE CRAFTS

Mississippi Crafts Center
Natchez Trace Exit from I-55 North
950 Rice Road, Ridgeland • 601-856-7546

The new Mississippi Craft Center was designed specifically for the display and demonstration of craft. The center is a showplace of both traditional and contemporary folk arts and crafts of our state. Informative exhibits and live demonstrations involve visitors in the artistic process.

- Tour Time: 30 minutes-1 hour
- Hours: Monday-Sunday 9 a.m.-5 p.m.
- Admission: Free/Donations accepted

Special Services:

- Fine craft shops
- Restrooms
- Drinking fountains
- Motorcoach parking
- Handicap accessible
- Special calendar for craft demonstrations is available upon request.

AREA ARTS ORGANIZATIONS

*Arts and cultural organizations in the area are plentiful and very diverse,
and offer fine performing and visual arts.*

*For current schedules, please
call the organizations listed here.*

American Guild of Organists	601-362-3235	Mississippi Department of Archives & History ..	601-576-6850
Ballet Magnificat	601-977-1001	www.mdah.state.ms.us	
www.balletmagnificat.com		Mississippi Humanities Council	601-432-6752
Ballet Mississippi	601-960-1560	www.mshumanities.org	
www.balletms.com		Mississippi Mass Choir	601-366-8863
Belhaven University.....	601-968-5940	www.themississippimasschoir.com	
www.belhaven.edu		Mississippi Metropolitan Ballet	601-853-4508
Community Children's Theatre	601-354-1191	www.msmetroballt.com	
Eudora Welty Library System	601-968-5811	Mississippi Murder Mysteries	601-331-4045
Fondren Theatre Workshop	601-982-2217	www.missmurdermystery.com	
Greater Jackson Arts Council	601-960-1557	Mississippi Museum of Art	601-960-1515
www.jacksonartscouncil.org		www.msmuseumart.org	
Jackson Arts Collective	601-942-7285	The Mississippi Opera	601-960-2300
Jackson Choral Society	601-927-9604	www.msopera.org	
www.jacksonchoralsociety.org		Mississippi Poetry Society	601-856-3635
Jackson Public School's Academic & Performing Arts Complex (APAC) Performing Arts Division	601-960-5387	Mississippi Puppetry Guild	601-977-9840
Jackson State University	601-979-2040	www.mspuppetry.com	
www.jsums.edu		Mississippi Symphony Orchestra	601-960-1565
Metropolitan Chamber Orchestra Society	601-366-3457	www.msorchestra.com	
Millsaps College	601-974-1039	Municipal Art Gallery	601-960-1582
www.millsaps.edu		http://www.jacksonms.gov/visitors/museums/Municipal	
Mississippi Academy of Ancient Music	601-852-4848	New Stage Theatre	601-948-3533
revolvingpaintdream.com/ancientmusic		www.newstagetheatre.com	
Mississippi Artists Guild	601-373-1110	Puppet Arts Theatre	601-956-3414
Mississippi Arts Center	601-960-1500	Tougaloo College	601-977-7839 or 1-888-42GALOO
Mississippi Arts Commission	601-359-6030	www.tougaloo.edu	
www.arts.state.ms.us		USA International Ballet Competition, Inc	601-355-9853
Mississippi Chorus	601-278-3351	www.usaibc.com	
www.mschorus.org		Very Special Arts of Mississippi	601-713-3311
Mississippi Community Symphonic Band.....	601-605-2786	W. Kessler, Ltd.	601-981-1847
www.MCSB.us		www.kesslerbroadway.com/	

ANNUAL EVENTS



January

- Mississippi Blues Marathon601-624-7882
- Dixie National Livestock Show & Rodeo601-961-4000
- Martin Luther King, Jr. Celebration & Parade601-960-1090
- Jackson Jewish Film Festival601-956-6215
- Premier Bridal Show601-957-1050
- Mississippi Bridal Show & Expo601-988-1142

February

- Gem & Mineral Show601-961-4000
- Mississippi Hearts Against AIDS Benefit601-366-9084

March

- Bagwell Antiques Show662-844-3095
- Ballet Magnificat! Spring Concert601-977-1001
- Mal's St. Paddy's Day Parade601-984-1972
- Zippity Doo Dah Weekend601-981-9606
- Mississippi Metropolitan Ballet Spring Performance601-853-4508
- National Cutting Horse Association Events601-961-4000
- Puppetry Jam601-977-9840
- Taste of Mississippi601-353-2759
- Zoo Day601-352-2581
- Jackson Garden and Patio Show601-919-8111

April

- Art, Eats and Beats601-981-9606
- Crossroads Film Festival601-510-9148
- Spring Festival at Mynelle Gardens601-960-1894
- Easter Egg Hunt & Parade601-432-4500
- Easter Sunrise Service601-432-4500
- Annual Lynch Street Heritage Festival601-352-6993
- Sante' South Wine Festival601-987-0200
- NatureFEST601-354-7303

May

- Canton Flea Market601-859-8055
- Pepsi Pops Concert601-960-1565
- Take a Tasty Bite Out of Crime601-968-9999
- Zoo Brew601-352-2581
- Trail of Honor601-372-5770

June

- USA International Ballet Competition601-355-9853
(2014)
- Mississippi Pride Festival601-376-9688
www.mississippipride.com

July

- Fourth of July Celebration at The Cedars601-981-9606
- Black Rodeo903-753-3165
- Ice Cream Safari601-352-2581
- Old Fashioned 4th of July Celebration601-432-4500

August

- Bright Lights, Belhaven Nights Street Festival601-352-8850
- Mississippi Wildlife Extravaganza601-354-7051
- Mississippi Animal Rescue League Annual Fur Ball ...601-607-3411

September

- Celtic Fest601-432-4500
- Farish Street Heritage Festival601-948-5667
- Symphony at Sunset601-981-9606
- Wellsfest601-353-0658
- Zoo Party601-352-2582

October

- Bagwell Antiques Show662-844-3095
- Canton Flea Market601-859-8055
- Boo at the Zoo601-352-2581
- Pumpkin Adventure601-432-4500
- Mississippi State Fair601-961-4000
- Mississippi Watercolor Grand National Exhibition ...601-960-1515

November

- Capital City Football Classic601-979-2450
- Fondren Unwrapped601-981-9606
- Handworks Holiday Market601-981-1052
- Harvest Festival601-432-4500
- Mistletoe Marketplace601-948-2357

December

- Annual Christmas Tree Festival601-960-1457
- Ballet Magnificat—Snow Queen601-977-1001
- Belhaven Singing Christmas Tree601-968-5930
- Chimneyville Crafts Festival601-981-0019
- Christmas at the Governor's Mansion601-359-6421
- Christmas at the Oaks601-353-9339
- Holiday Show at New Stage601-948-3431
- City of Jackson Christmas Parade601-960-1084
- "Old Jackson Christmas by Candlelight" Tour601-576-6920
- Puppet Wonderland601-977-9840
- Miss. State Kennel Club Magnolia Christmas Classic ...601-924-5510
- Kwanzaa Celebration at the Medgar Evers Center601-960-1741

LOCAL TRANSPORTATION

LIMOUSINE SERVICE

Act One Limousine Service
P.O. Box 16053 • 601-919-1077

Celebrity Limousine
2440 Bailey Avenue • 601-362-4055

Commodore Coaches & Sales
2310 Hwy. 80 West • 601-969-9010

Excel Limousine, Inc.
1336 S. Gallatin St. • 601-969-0078

LeFleur's Limousine
5454 I-55 North • 601-956-5466

Mr. Limo
601-605-0318

Super Limo
975 I-20 Frontage Rd. • 601-672-7770
www.superlimo.biz

CAR RENTAL AGENCIES

Alamo Rent-A-Car
877-227-8367 • 601-939-5713

Avis Rent A Car
Jackson International Airport • 601-939-5853
800-331-1212

U-Rental, Inc.
2310 Highway 80 West
601-961-4411

Budget Car & Truck Rental
Jackson International Airport
800-527-0770 • 601-932-2126

Enterprise Rent-A-Car
800-736-8222

5355 I-55 North • 601-981-4446
101 South State Street • 601-948-0062
Jackson International Airport • 601-420-3142

Hertz Rent A Car
Jackson International Airport
800-654-3131 • 601-939-5312

National Car Rental
Jackson International Airport
601-939-5713 • 1-800-227-7368

U-Save Auto Rental
5454 I-55 North, Suite C • 601-957-8728

CITY BUS SERVICE/TROLLEY

Fondren Express
3502 North State Street
601-213-7433

JATRAM
1025 Terry Road
601-948-7140

TAXICABS

Citi-Cab Co.
300 North Mill Street • 601-355-8319

Deluxe Cab
593 Terry Road • 601-948-4761

Veterans Cab
973 Highway 80 West • 601-355-2222

Yellow Cab Co.
5601 Highway 80 West • 601-922-3782

GUIDE & CONVENTION SERVICES COMPANIES



All of these guides are highly professional and very dependable.

*Should you need further assistance booking a guide, or if any problem arises,
please contact the Jackson Convention & Visitors Bureau
at 1-800-354-7695 (outside MS) or 601-960-1891.*

CONVENTION SERVICES COMPANIES

Bowie Audio Visual
290 Highpoint Drive • 601-957-6566
Audio-visual systems

Convention Display Services
908 Larson Street
601-948-4228 • FAX 601-352-3234
Complete displays for any size shows.

Jaki's Costumes & Party World
5404 I-55 North • 601-957-2999
Audio/visual systems, sound & lighting systems, costumes, and more.

Jasper Ewing & Sons, Inc.
1220 East Northside Drive, Suite 370
601-981-2178 • FAX 601-981-2264
Audio/visual systems, video, and sound

Sound and Communications, Inc.
5830 North State Street
601-957-5830 • FAX 601-956-6358
Sound

Tech Plus Audio Visual Services
2310 Highway 80 West
601-961-9700 • FAX 601-961-9712
Audio/visual systems, video, and sound

Thomas Audio Services
878 Foley Street
601-354-9050 • FAX 601-352-8346
Rental systems, recording/video, production services

Top It Off
4800 I-55 North, Suite 16 • 601-362-8861
Party supply rentals, table linens, chairs, white tents & disposables

Xerox Audio Visual Solutions
405 Briarwood Drive, Suite 210C
601-899-5574

STEP-ON GUIDE SERVICE

African American Heritage Tours
118 Blueberry Lane • Clinton
601-260-3337
Contact: Clotie Graves
Student tours, church groups, family reunions, seniors, groups of all ages, and tour planning.

Jerry Ainsworth
Hinds Community College • 601-383-2566
Step-on guide for motor coach tours.

Clinton Bagley – Tour Guide
601-576-6850
Licensed Mississippi tour guide.

Custom Tours
601-845-2989 or cell: 601-540-1098
Contact: Forrest Cooper
Motorcoach tours, customized tours for individuals or small groups.

Silver Platter Tour Travel
5903 Ridgewood Road, Suite 240
601-206-1234 or cell: 601-953-9999
Contact: Maureen Watt
Motorcoach, tour planner, receptive, customized local or regional tours for individuals or small groups.

TOURS & CHARTER COMPANIES

Action Travel & Tours
1600 Airport Drive
601-948-2096
<http://actiontravelandtours.com>

Services:
• Charters
• Rentals
• Travel Agent
• Receptive Operator

**BSCI Tour & Travel
(Bus Supply Charters, Inc.)**
710 Magnolia Street • Madison
800-272-7106 • 601-898-3511
FAX 601-898-7760
Email: bscitt@aol.com
www.bscitourandtravel.com

Services:
• Charters
• Escorted tours
• Cruises
• International tours
• Day trips
• Student tours
• Full service travel agent
• Member ABA, NTA, UMA, TMCA/SCMA, CLIA, IATAN/SYTA

Capital Trailways of Mississippi
451 Highway 49 South • Richland
1-800-841-6817 • 601-939-0519
FAX 601-939-1607
Email: capital@capital-trailways.com
www.capital-trailways.com

Services:
• Charters
• Airport transfers
• Shuttle
• Convention & Meeting Planning
• Tour planning
• Member ABA, AMA, SCMA, UMA

Cline Tours

277 Commerce Park Drive • Ridgeland

1-800-233-5307 • 601-605-4483

FAX 601-605-2562

www.clinetours.com

Services:

- Package tours
- Charters
- Rentals
- Contract & corporate shuttle
- Airport transfers
- Member ABA, UMA/CLIA

Fondren Express Trolley

3502 N State Street

601-213-7433

www.fondrenexpress.com

Services:

- Small group charters
- Themed trolley tours

Leeway Tours

22592 Highway 17N • Lexington

662-834-2953 office • 662-392-5492 cell

*Now that you've seen how much we have to offer,
let us extend a personal invitation to
come and sample it all for yourself.
Call us today at 1-800-354-7695 or
601-960-1891. We'll help you with your
planning, inform you of the facilities and lodgings
that best suit your group, offer suggestions
on dining, and help you handle the many details
that go into making your stay a most pleasant one.
From start to finish, you'll find it right here in
Jackson, the City with Soul.*